

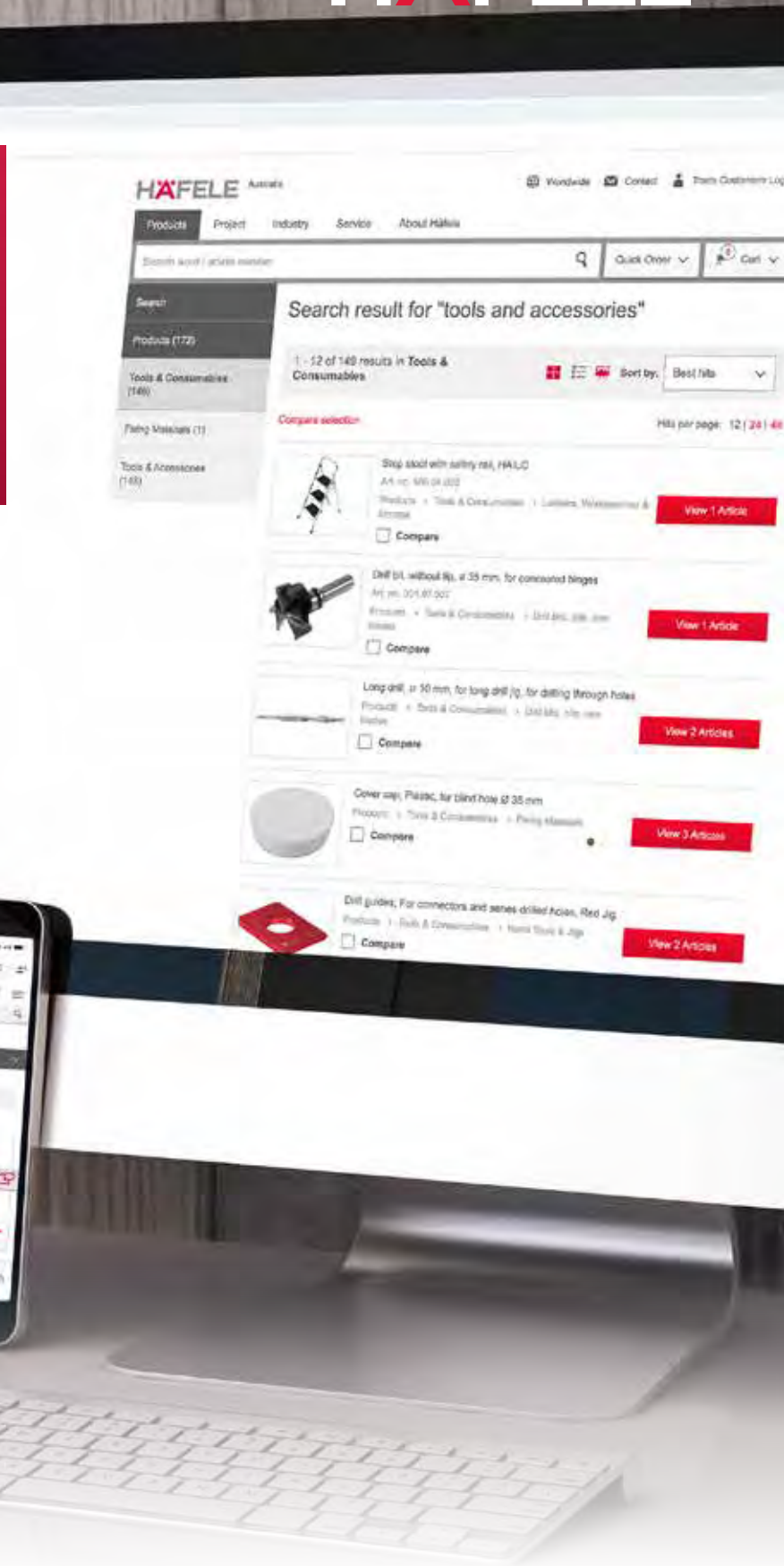

## CONSUMABLES & TOOLS

Brought to you by Häfele

Get up to date  
stock & pricing  
information, on all  
the products  
in this catalogue.  
Plus much more!

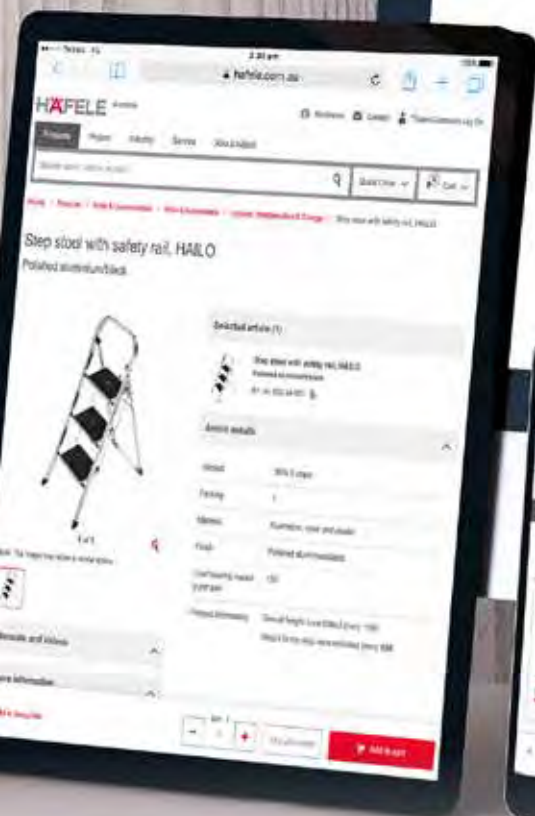

## hafele.com.au

order online now!

# CONSUMABLES & TOOLS

Dimensions in mm. Dimensional data not binding. We reserve the right to alter specifications without notice.



CLAMPS & HAND TOOLS

PAGE

04-12



ADHESIVES, SEALANTS,  
SURFACE REPAIR & TAPES

PAGE

49-58



MEASURING TOOLS

PAGE

13-14

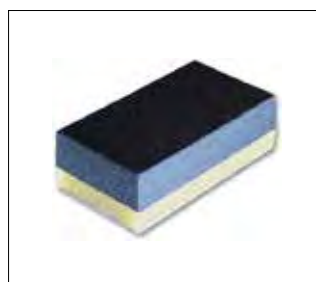

ABRASIVES

PAGE

59-66



DRILLING AIDS & MARKING  
TEMPLATES

PAGE

15-18



PACKING MATERIAL

PAGE

67-69



DRILL BITS, SCREW BITS &  
JIGSAW BLADES

PAGE

19-23



MATERIAL HANDLING

PAGE

70-74



SCREWS, COVER CAPS &  
FASTENERS

PAGE

24-48

## BESSEY TG/TGK SCREW-CLAMP



- > Tensioning arms: Malleable cast, wooden handle, with ergonomic handle
- > Model TG: with protective cap on the clamping surfaces, clamping force up to 6,000 N
- > Model TGK: without protective cap on the clamping surfaces, clamping force up to 7,000 N

Opening (mm)	Throat depth (mm)	Model	Cat. No.
100	50	TG10	003.69.801
160	80	TG16	003.69.803
200	100	TG20	003.69.804
250	120	TG25	003.69.805
300	140	TG30	003.69.806
400	175	TG40	003.69.807
500	120	TGK50	003.69.808
600	120	TGK60	003.69.809
800	120	TGK80	003.69.810
1000	120	TGK100	003.69.811
1250	120	TGK125	003.69.812
1500	120	TGK150	003.69.813
2000	120	TGK200	003.69.815

Packing: 1 piece

## BESSEY GZ ALL STEEL SCREW-CLAMP



- > With ergonomic handle, clamping force up to 6,000 N
- > Material: tensioning arms all-steel, tempered, wooden handle

Opening (mm)	Throat depth (mm)	Cat. No.
120	60	003.71.013
160	80	003.71.022
200	100	003.71.031
250	120	003.71.040
300	140	003.71.059
400	120	003.71.068
600	120	003.71.077

Packing: 1 piece

## BESSEY KLI KLAMP LEVER CLAMP



- > Gentle tightening due to swivelling pressure plate, lightweight and stable, clamping force up to 1,200 N
- > Material: fixed and sliding jaw made of magnesium, ratchet made of glass fibre reinforced plastic

Opening (mm)	Weight (kg)	Throat depth (mm)	Cat. No.
150	Approx. 0.29	80	003.71.102
200	Approx. 0.32	80	003.71.103
250	Approx. 0.355	80	003.71.104

Packing: 1 piece

## BESSEY EZ ONE HANDED CLAMP



- > For clamping and spreading
- > Handy two component handle for quick and precise clamping pressure, quick tightening provided by pistol grip and instant release on pressure, clamping jaws with protective caps, clamping force up to 2,700 N
- > Material: hardened steel clamping rail, plastic protective caps

Opening (mm)	Throat depth (mm)	Spreading width (mm)	Cat. No.
150	60	125-270	003.72.805

Packing: 1 piece

BESSEY KT EDGE CLAMP



- > For tightening strips and edge bands, for clamping onto profile rails of screw-clamps, suitable for use with commercial screw-clamps with max. rail thickness of 13 mm
- > Material: steel body, wooden handle

Cat. No.
003.71.719

Packing: 1 piece

BESSEY EZS ONE-HANDED CLAMP



- > Universal quick action clamp for clamping and spreading
- > Handy two component handle for quick and precise clamping pressure, for clamping the clamping jaw in any position on the rail, clamping jaws with protective caps, fast switching between clamping and spreading clamp, clamping force approx. 2,000 N
- > Material: hardened steel clamping rail, plastic protective caps

Opening (mm)	Throat depth (mm)	Spreading width (mm)	Cat. No.
150	80	170-360	003.72.800
300	80	170-510	003.72.801
450	80	170-660	003.72.802
600	80	170-810	003.72.803

Packing: 1 piece

BESSEY UNI KLAMP UNIVERSAL CLAMP



- > For clamping and spreading of sensitive surfaces, round and sharp workpieces with large clamping surfaces, also tightens on the side and behind the rail, clamping force up to 1,500 N

Opening (mm)	Throat depth (mm)	Spreading width (mm)	Rail (mm)	Weight (kg) approx.
160	80	172-270	20 x 5	0.6
600	80	172-270	20 x 5	0.93

Opening (mm)	Cat. No.
160	003.72.721
600	003.72.723

Packing: 1 piece



## CAM CLAMP



- > Material: tensioning arms made of hornbeam, steel rails, clamping surface cork coated

Opening (mm)	Throat depth (mm)	Cat. No.
200	110	003.73.026
400	110	003.73.044
600	110	003.73.062

**Packing:** 1 piece

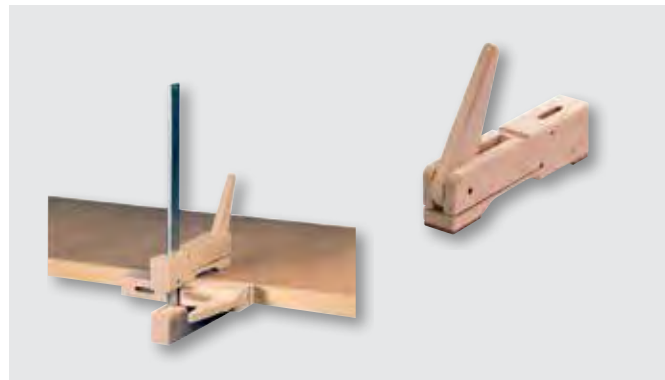

- > For additional tightening of edges and edge bands or as replacement tensioning arm
- > Material: hornbeam

	Cat. No.
Combination replacement part	003.73.106

**Packing:** 1 piece

## BESSEY REVO KR BODY CLAMP



- > Very large parallel clamping surfaces with 3 removable protective caps to protect delicate surfaces, can be converted to spreading function without tools, high quality 2-component plastic handle with hexagon socket for comfortably reaching the clamping force (max. torque 17 Nm)
- > Metal reinforced plastic housing and optimised sliding arm with double slide protection for more power and reliability
- > The clamping force is maintained and any unintentional slipping of the sliding arm is prevented when in the unclamped position
- > Clamping force: ≤8000 N

Opening (mm)	Throat depth (mm)	Spreading width (mm)	Cat. No.
600	95	730	003.72.205
800	95	930	003.72.206
1000	95	1130	003.72.207
1250	95	1355	003.72.208

**Packing:** 1 or 2 pieces

## BESSEY PS 130 SEAMING TOOL



- > For tightening and positioning large-scale, also heavy components with a smooth surface, such as artificial stone, ceramic, granite, Corian®, plastic, sheet metal and glass
- > Vacuum pumps with control function, clamping force up to 1,200 N, with release button for quick removal, robust design
- > Vacuum cup: Ø210 mm
- > Length: 770 mm

	Cat. No.
	006.69.000

**Packing:** 1 piece

## BESSEY ONE-HANDED EDGE CLAMP

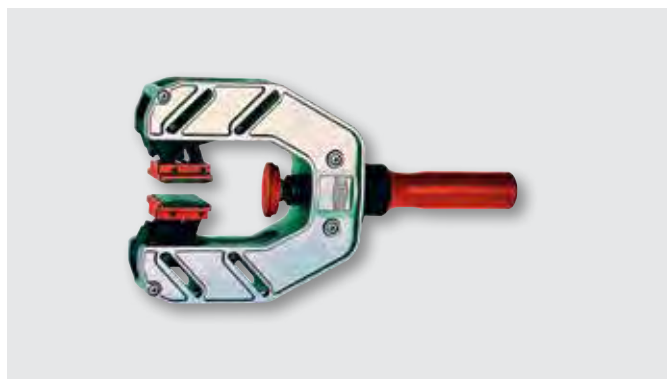

- > With micro-coated surface (does not rub off), with removable plastic caps, with ergonomic handle, with double spindle (outer spindle moves jaws, inner spindle generates pressure on the edge)
- > Material: aluminium housing, yellow chromatised pressure plates, impact-resistant plastic handle
- > Weight: 0.82 kg

Opening (mm)	Throat depth (mm)	Cat. No.
10-55	0-45	003.73.830

Packing: 1 piece

## BESSEY CLIPPIX SPRING CLAMP



- > Versatile, can be used as a cam clamp, for example with non-slip grip pads with softpads for sensitive workpieces

Opening (mm)	Throat depth (mm)	Cat. No.
50	50	003.75.120
75	70	003.75.130

Packing: 1 or 10 pieces

## BESSEY AV2 SPACER



- > For floating installation of laminate and prefinished parquet floors without wedges, continuously adjustable for wall distance 5 - 20 mm, with practical turn knob, wide clamping and support surface, with millimetre scale, robust, light and compact
- > Material: plastic

	Cat. No.
	003.71.661

Packing: 4 pieces

## BESSEY STC-HH50 QUICK-ACTION CLAMP



- > Horizontal toggle clamp with open arm
- > Clamp more flexibly and up to 5x faster, sensitive workpieces with a veneered or lacquered surface, for example, can be clamped without damage, adapts to workpieces with different thicknesses with approximately equal clamping force, without manually adjusting the pressure screw
- > Extremely wide tightening range thanks to patented mechanism, clamping force regulation via adjusting screw in joint
- > Automatic adjustment: 35 mm
- > Clamping force: 2,500 N
- > Opening: 40 mm

	Cat. No.
	003.71.240

Packing: 1 piece

BESSEY EZR15-6 ONE-HANDED CLAMP

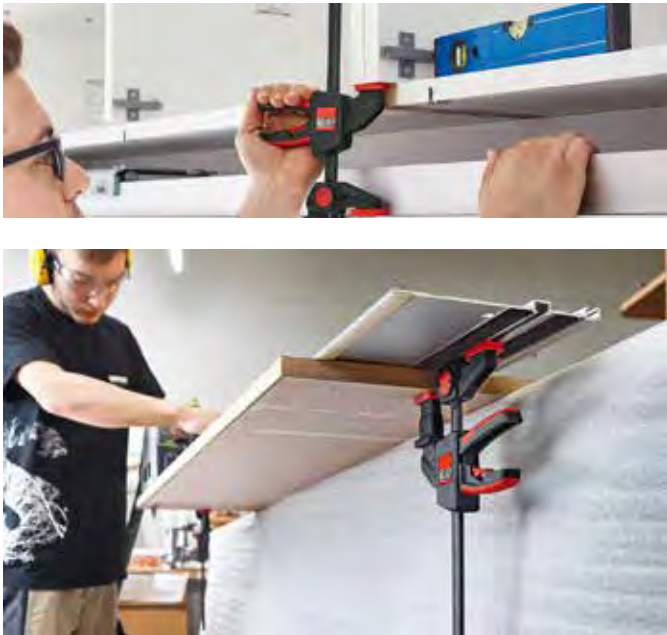

- > With special guide on the top section for grooves 12 x 6.5 mm to 12 x 8 mm
- > Use with adapter on the bottom section and rotated top section for secure fastening of guide rails from Festool, Protool, Metabo, Makita, Hitachi/Hikoki, Dewalt, etc. and for clamping in profiles and on work benches.
- > Use with adapter on the top or bottom section for step-over clamping
- > Use with or without adapter for clamping or spreading
- > Clamping force up to 750 N
- > Ergonomically shaped 2-part plastic handle with pump lever behind the rail

Opening (mm)	Throat depth (mm)	Spreading width (mm)	Cat. No.
150	60	120-310	003.69.890

Packing: 1 piece

LITTLE HAND

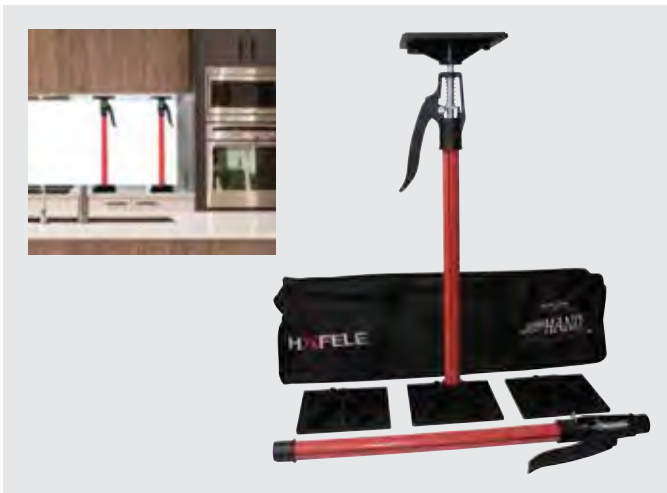

- > The little hand is designed to support over head cabinets during installation after the base cabinets have been fitted
- > Height adjustable from 600 mm up to 950 mm via an ergonomic pump mechanism
- > Micro adjustment
- > Non marking, anti slip pads

Cat. No.
003.71.592

Packing: 1 set (2 pieces)

3RD HAND



- > The third hand is designed to support overhead cabinets during installation where there are no base cabinets in place
- > Ideal for fitting cupboards above fridge cavities, putting up cornice, beading and many other applications
- > Height adjustable from 1448 mm up to 3658 mm via and ergonomic pump
- > Micro adjustment
- > Non marking, anti slip pads

Cat. No.
003.71.576

Packing: 1 set (2 pieces)



## JOINER'S HAMMER



- > Standard: DIN 5109
- > Material: ash handle

Weight (g)	Cat. No.
320	006.00.055
450	006.00.064

**Packing:** 1 piece

## RUBBER Mallet



- > For mounting fittings without damage, does not leave any marks
- > Material: rubber head, ash handle
- > Finish: natural white head, polished handle

Head Ø (mm)	Length (mm)	Weight (g)
75	360	820

	Cat. No.
	006.00.492

**Packing:** 1 piece

## PLASTIC Mallet/Soft Faced Hammer



- > For the careful installation of fittings
- > Material: cellulose-acetate head, ash polished handle

Length (mm)	Head Ø (mm)	Weight (g)
270	27	215
290	35	400

Length (mm)	Cat. No.
270	006.00.461
290	006.00.463

**Packing:** 1 piece

## UNIVERSAL DEMOLITION PRY BAR



- > For prying, splitting, benching and hitting
- > Material: carbon steel forged
- > Weight: 2 kg

Length (mm)	Cat. No.
460	008.42.220

**Packing:** 1 piece

## LONG NOSE PLIERS WITH CUTTING EDGE (NEEDLE-NOSE PLIERS)



- > For gripping, holding, cutting soft and hard wires or cables, straight shape, with extra-long cutting edge for flat and round cables, partially serrated gripping surfaces, robust and durable
- > Standard: DIN ISO 5745
- > Material: high-quality tool steel, tempered

Length (mm)	Cat. No.
200	006.12.030

**Packing:** 1 piece

## SIDE CUTTING PLIERS



- > For hard and soft wire, low wear and tear and suitable for heavy-duty use, head semi-circular, Swedish style, with specially milled precision cutters for clean cuts
- > Standard: DIN ISO 5749
- > Material: high-quality tool steel, tempered

Length (mm)	Cat. No.
160	006.13.420

**Packing:** 1 piece

## COMBINATION PLIERS



- > Universally usable for gripping, holding, cutting soft and hard wires or cables, with extra-long cutting edge for flat and round cables, partially serrated gripping surfaces, robust and durable
- > Standard: DIN ISO 5746
- > Material: high-quality tool steel, tempered

Length (mm)	Cat. No.
180	006.11.186

**Packing:** 1 piece

## PINCERS



- > Low wear and tear and suitable for heavy-duty use, classic head shape, with precision blade for high cutting performance, for pulling and cutting nails and wires, suitable for binding wires
- > Standard: DIN ISO 9242
- > Material: high-quality tool steel, tempered

Length (mm)	Cat. No.
220	006.10.200

**Packing:** 1 piece

## WATERPUMP PLIERS WITH PUSH BUTTON ADJUSTMENT



- > For gripping and holding tubes, profiles and hexagonal nuts, with push button adjustment for fast setting and locking mechanism, with extra narrow head for working in hard to reach places, optimum adaptation to object to be gripped by finely adjustable, through bolt joint, robust and durable

Length (mm)	External tube Ø (mm)	Key size (mm)
250	1/8-2"	6 – 50

Length (mm)	Cat. No.
250	006.11.510

**Packing:** 1 piece

## LAMINATE ROLLER



- > Used to apply pressure to area where high strength bonds are required, ideal for use on kickboards, laminate panels and edge strips, light weight, ergonomic handle
- > Extendable: 450 mm to 700 mm

Width of roller (mm)	Height (mm)	Length (mm)
190	100	450
		Cat. No.
		008.54.549

**Packing:** 1 piece

## WORKTOP JIG

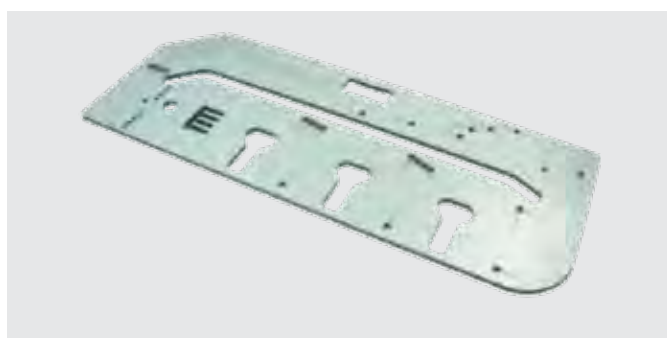

- > Rout recesses for worktop connecting bolts, for right and left standard 90° and 45° joints
- > Easy to follow symbols, convenient carrying handle, for 400-700 mm worktops

	Cat. No.
	002.13.565

**Packing:** 1 piece

## SPEEDROLLER

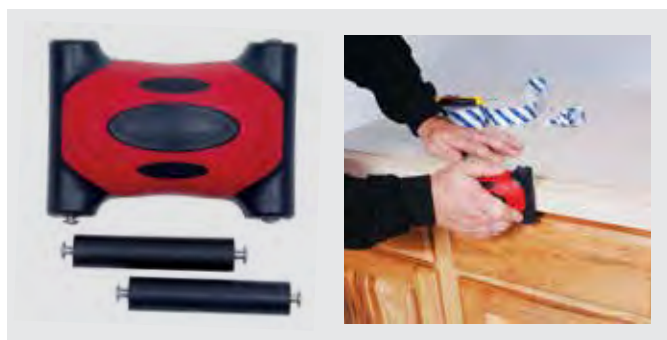

- > Ergonomically designed laminate rollers that can be used for any PSA application (especially SpeedTape)
- > SpeedRollerPRO includes 2 sets of interchangeable wheels
- > SpeedRoller Quad has all the wheels attached.

	Cat. No.
SpeedRollerPRO	003.69.520
SpeedRoller Quad	003.69.521

**Packing:** 1 piece

## QUAD PRO TRIMMER



- > Makes trimming edge banding quick and easy, with a comfortable and ergonomic design, it trims both sides of the edge banding in just one pass, no springs, all pneumatic
- > Cuts forwards, backwards and both sides at once from 12.7 mm to 19.05 mm

	Cat. No.
	004.54.024

**Packing:** 1 piece

HÄFELE POZIDRIVE SCREWDRIVER

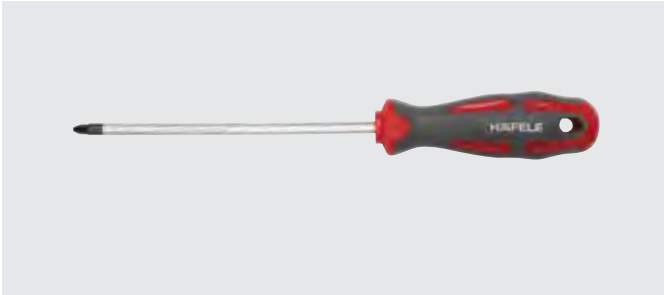

- > Precise blade fit means maximum torque during use, hexagonally shaped handle prevents screwdriver rolling away
- > Material: chrome vanadium steel magnetised tip, durable plastic handle with soft inserts

	Cat. No.
PZ2 x 150 mm	006.28.010

Packing: 1 piece

HEXAGON KEYS (ALLEN KEYS)



- > Material: steel, galvanised

Size	A (mm)	B (mm)	Cat. No.
SW3	60	22	008.28.230
SW4	66	28	008.28.241
SW5	86	36	008.28.250

Packing: 1 piece

POZIDRIVE SCREWDRIVER



- > Precise blade fit means maximum torque during use, hexagonally shaped handle prevents screwdriver rolling away
- > Material: chrome molybdenum vanadium steel tip, tough plastic handle with soft inserts

	Cat. No.
PZ2 x 205 mm	006.28.302

Packing: 1 piece

HEX KEY SET



- > Supplied with: 1 each of SW 2, 2.5, 3, 4, 5, 6, 8 mm

	Cat. No.
	006.28.410

Packing: 1 piece

AWL



- > With wooden handle and striking cap

Length (mm)	Cat. No.
180	001.29.750

Packing: 1 piece

FINE-TOOTHED SAW



- > For fine cuts, with folding handle
- > Cutting height: 40 mm
- > Saw blade length: 250 mm

Length (mm)	Cat. No.
375	000.56.888

Packing: 1 piece

CHISEL SET



- > With plastic cap protecting the blade
- > Material: beech wood handle, with striking ring, forged steel blade
- > Standard: DIN 5139
- > Supplied with: 1 piece each of 6, 10, 12, 16, 20, 25 mm

	Cat. No.
	000.30.210

Packing: 1 set (6 pieces)

WOODEN FOLDING RULER



- > Material: steel hinges, elements made of birch, natural lacquered
- > Width: 16 mm

Length (mm)	Cat. No.
2000	002.80.204

Packing: 1 piece

DIGITAL CALLIPER



- > 4-fold measurement, accuracy 0.01 mm, with LCD display, clamping screw, thread table and replacement battery, display in mm and inch, with depth measurement
- > Material: rustproof steel

Range (mm)	Cat. No.
150	002.81.988

Packing: 1 piece

PARALLEL SCRIBER WITH PENCIL



- > Pencil is held automatically
- > Material: plastic blue
- > Opening width: 0-85 mm

	Cat. No.
	002.81.846

Packing: 1 piece

ACCUSCRIBE PRO



- > Makes it easy to maintain a consistent scribe offset, staying parallel to the object surface every time, it is ideal for scribing trim on kitchen cabinets, architectural moldings, countertops, splash guards, tile and even flooring, fits a standard pencil, Sharpie, or FatBoy Pencil
- > Flat bottom for precise marking, retractable compass point, built-in pencil sharpener

	Cat. No.
	002.81.850

Packing: 1 piece

MAG SQUARES



- > Make squaring up your saws and equipment effortless. The Mag Square 45 Degree sets your blade to a precise 45 degree with zero guess work with a magnetic base that sticks firmly to the cast iron or metal table and allows hands-free adjustment spindles, blades and fences. The of built-in scale allows you to easily set the height or do precision layout for finish carpentry

	Cat. No.
Magnetic Micro Square	002.82.223
Magnetic Square 45 degree	002.82.224

Packing: 1 piece



PRECISION ANGLE GAUGE



- > 2 vials, with large LCD display, with angle indicator of 0-185° (accuracy  $\pm 0.1^\circ$  resolution 0.05° ), with switchable illumination, automatic switch-off after 5 min, stores the last value after switch-off, with hold function, allows a reading of the values of opaque jobs, with position independent reset function, zero of the angle gauge in every position possible, operating time approx. 1.5 years
- > Material: aluminium, powder coated red
- > Weight: 460 g
- > Voltage supply: 2 x AAA

Length (mm)	Cat. No.
348	002.82.900

Packing: 1 piece

SOLA ENW ANGLE ELECTRONIC SPIRIT LEVEL



- > Use in any situation where angles and gradients need to be determined quickly, comfortable to read with reversible display for reverse positions, when taking measurements overhead, the display automatically rotates accordingly, with hold function for storing measured values and for transferring angles, acoustic signal guide is available for difficult visibility conditions, it indicates the distance to the standard position, this makes it a valuable tool for users who need to have their hands free to carry out other tasks, for example mounting of furniture, adjustable inclination display in °, %, mm/m and in/ft
- > Material: aluminium, silver coloured anodised
- > Dimensions: 59 x 27 mm
- > Weight: 890g/m
- > Measuring tolerance of standard position: 0.50 mm/m (0.029°)
- > Measuring tolerance of reverse position: 0.50 mm/m (0.029°)
- > Measuring tolerance of Solatronic module: 0.05 0.1° between 1° and 89° ° at 0° and 90°
- > Degree of protection: IP65

Length (mm)	Cat. No.
600	002.84.070

Packing: 1 piece

SOLA BIG X SPIRIT LEVEL



- > 1 horizontal vial and 1 vertical vial, 2 vertical vials at length 1,000 mm
- > Measuring accuracy: 0.5 mm/m (0.029°) at standard position, 0.75 mm/m (0.043°) at reverse position, horizontal vial magnified for improved allround visibility and luminous surface, vials are adjusted electronically
- > Material: aluminium, powder coated red
- > Dimensions (W x H): 25 x 51 mm

Length (mm)	Cat. No.
600	002.84.074
800	002.84.075
1000	002.84.076

Packing: 1 piece

SOLA BIG RED SPIRIT LEVEL



- > With 2 hand grips, with unbreakable acrylic glass vials (1 horizontal vial, 2 vertical vials), with magnified display of the bubble (up to 30% larger)
- > Measuring accuracy 0.5 mm/m (0.029°) in standard measurement/reverse position
- > Material: aluminium, powder coated red
- > Dimensions (W x H): 26 x 59 mm
- > Weight: 1.6 kg

Length (mm)	Cat. No.
1800	002.84.079

Packing: 1 piece

## DOOR HANDLE DRILLING JIG



- > For board material width up to max. 800 mm, for efficient and exact drilling of drill holes for handles and knobs
- > With adjustable side and depth gauges, depth gauge with a 45° angle, can be used on both sides (reversed)
- > Material: extremely tough polycarbonate
- > Adjustment range: horizontal up to 420 mm, vertical up to 125 mm

	Cat. No.
Drilling jig	001.35.001
Drilling jig repair kit	001.35.020

**Packing:** 1 piece

## HANDLE TEMPLATE



- > For pre-drilling of handles and knobs, suitable for cabinet doors, flaps and fronts up to a maximum width of 320 mm
- > With fixed drilling positions to suit System 32 drilling
- > Material: plastic

	Cat. No.
	001.35.090

**Packing:** 1 piece

## CIRCULAR CUTTER



- > Dust protected working on ceiling, wall and floor areas, max. cutting depth 30 mm on one side or both sides 60 mm, easy, exact setting of the drill diameter, additional HSS blade set is also supplied for drill holes in plastic and acrylic
- > Supplied with: 1 hood, 1 twist drill bit, 1 HM blade set for wood, 1 HSS blade set for plastic and acrylic and 1 transport case

	Cat. No.
Circular cutter	001.67.018
Replacement blade for wood, HM-tipped	001.67.010

**Packing:** 1 piece

## LAYOUT TAPE SYSTEM



- > Designed for the 32mm European style adjustable shelving
- > For precise markings for line boring, works in any direction, non-marking collar on drill bit
- > Dimensions: 18 mtr roll (Layout Tape), Ø5 mm (Layout drill bit)

	Cat. No.
Layout Tape	001.27.030
Layout Drill Bit	001.27.031

**Packing:** 1 piece

HÄFELE FREE FLAP 1.7/FREE FLAP 3.15 DRILLING JIG

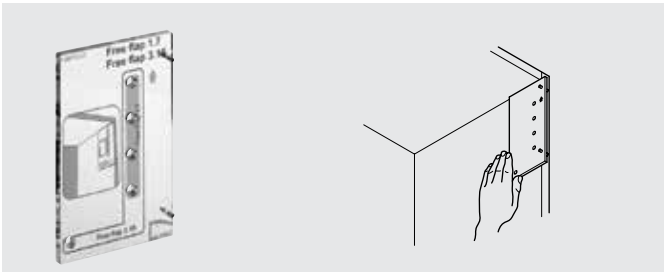

- > For pilot drilling the cabinet side components for mounting fittings with pre-mounted Euro screws
- > Material: acrylic glass with hardened steel inserts

	Cat. No.
	372.91.023

Packing: 1 piece

HÄFELE FREE UP DRILLING JIG

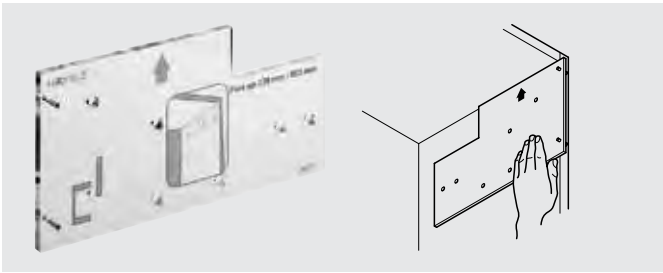

- > For pilot drilling the cabinet side components for mounting fittings with pre-mounted Euro screws
- > Material: acrylic glass with hardened steel inserts

	Cat. No.
	372.33.050

Packing: 1 piece

HÄFELE FREE FOLD-S DRILLING JIG

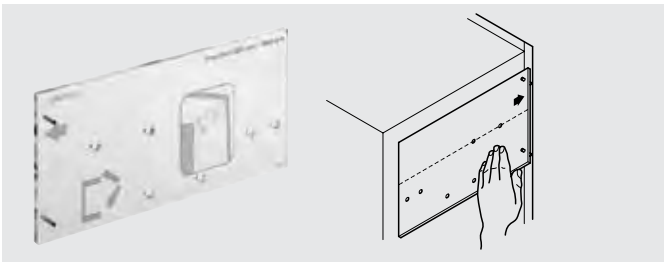

- > For pilot drilling the cabinet side components for mounting fittings with pre-mounted Euro screws
- > Material: acrylic glass with hardened steel inserts

	Cat. No.
	372.38.050

Packing: 1 piece

HÄFELE FREE SWING DRILLING JIG

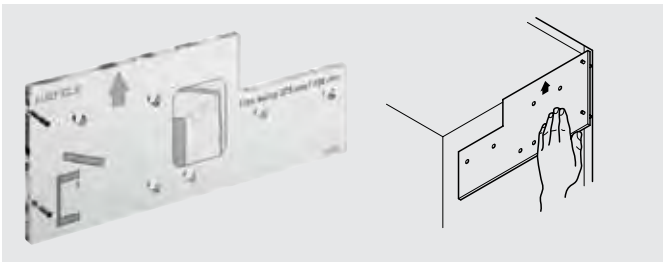

- > For pilot drilling the cabinet side components for mounting fittings with pre-mounted Euro screws
- > Material: acrylic glass with hardened steel inserts

	Cat. No.
	372.34.050

Packing: 1 piece

DRILLING JIG FOR FRONT FIXING BRACKETS

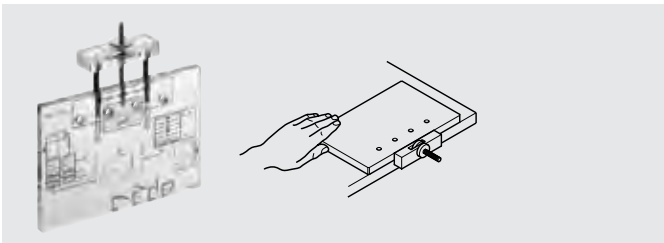

- > For pilot drilling the front panel for mounting screw-on brackets
- > Material: acrylic glass

	Cat. No.
	372.64.893

Packing: 1 piece

DEPTH GAUGE



- > For exact drilling of drill holes when using drilling jigs
- > Material: steel

Diameter Ø (mm)	Cat. No.
3	001.25.791
5	001.25.792

Packing: 1 piece

## DBB MORTICE JIG - SCREW ON VERSION



- > Self centring mortice jig with precision cutters complete with plastic carry case, screw-on design carbide tipped mortice wood cutters, cuts lock forend as well as lock body self centring action. Achieves an accurate depth of cut to hardwood and softwood doors. Use with a drill with 2000 - 3000 rpm with hammer action off and a 12.7 mm chuck
- > Max. mortice depth and shaft lengths (mm): Standard shaft: max. mortice depth 180 mm without depth stop, shaft length 220 mm long shaft: max mortice depth 180 mm, shaft length 298 mm
- > Max. door thickness (mm): 55 mm (standard housing), 80 mm (offset housing kit)
- > Max. vertical travel: (average 45 mm thick door) 240 mm door and frame with offset morticer max. 95 mm
- > Material: steel jig rods, aluminium housing and clamps

### MORTICE JIG CARRY CASE



- > Supplied with: 1 Mortice jig, 1 Standard screw-on shaft, 220 mm length (for locks up to 100 mm deep), 1 Ø19 mm carbide tipped cutter, 1 Ø22.2 mm carbide tipped cutter, 1 Ø25.4 mm carbide tipped cutter, Instruction booklet, 1 Allen key

	Cat. No.
	001.67.700

Packing: 1 set

### OFFSET HOUSING KIT



- > With side slide adjustment
- > Material: aluminium

	Cat. No.
	001.67.798

Packing: 1 piece

### ALUMINIUM CUTTER



- > Specially designed aluminium cutters in four sizes will shave out a lock slot in aluminium, but due to hot aluminium shavings safety clothing must be worn
- > Material: hardened steel

Diameter Ø (mm)	Cat. No.
16.2	001.67.870
19.0	001.67.871
25.4	001.67.872
31.8	001.67.873

Packing: 1 piece

### TIMBER CUTTER



- > New screw-on, anti-lock design

Material	Diameter Ø (mm)	Small bore (mm)	Standard bore (mm)
Hardened steel	13.2	001.67.840	-
	14.6	001.67.841	-
Carbide tipped	16.0	-	001.67.842
	17.5	-	001.67.843
	19.0*	-	001.67.844
	20.0	-	001.67.845
	20.6	-	001.67.846
	22.2*	-	001.67.847
	23.0	-	001.67.848
	23.8	-	001.67.849
	25.4*	-	001.67.850
	27.0	-	001.67.851
	28.6	-	001.67.852
	31.6	-	001.67.853

Packing: 1 piece (\* included in carry case set)

### PLUNGING CUTTER



- > Designed for locks where constrained door thickness may be an issue, 3 point plunging drill bit for precise and effective perfect installation results, achieves perfectly true holes used in conjunction with the DBB Mortice Jig (001.67.700), ideal for quick, accurate and straight fitting, for use with tubular latches, rack bolts and concealed type door closers (e.g Perkos) etc
- > Material: high speed steel

Diameter Ø (mm)	Cat. No.
17.6	001.67.860
23.0	001.67.861
25.4	001.67.862
29.0	001.67.863

Packing: 1 piece

## SHAFT

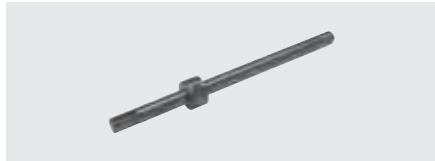

- > New screw-on shaft design
- > Small bore shaft: 100 mm mortice depth (optional) required for timber cutters 13.2 mm and 14.6 mm diameter
- > Standard bore shaft: 180 mm mortice depth (optional) required for timber and aluminium cutters 16.0 mm to 31.8 mm
- > Material: steel

Length (mm)	Small bore	Standard bore
220	001.67.740	001.67.742
298	-	001.67.743

**Packing:** 1 piece

## DEPTH STOP

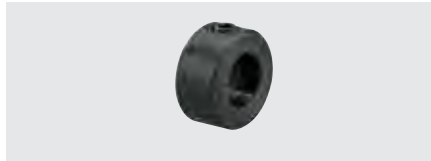

- > Material: steel

Cat. No.
001.67.747

**Packing:** 1 piece

## HOUSING KIT



- > Material: aluminium

Cat. No.
Small bore
Standard bore
001.67.791
001.67.706

**Packing:** 1 piece

## GRUB SCREWS AND ALLEN KEY



- > Set of 6 grub screws
- > Material: steel

Cat. No.
001.67.709

**Packing:** 1 set

## UPGRADE KIT FOR DBB MORTICER



- > For upgrading the DBB Mortice Jig from the snap-on cutters to the screw-on version
- > Supplied with: 1 Standard screw-on shaft, 220 mm length (for locks up to 100 mm deep), 1 Ø19 mm carbide tipped cutter, 1 Ø22.2 mm carbide tipped cutter, 1 Ø25.4 mm carbide tipped cutter, release spanner

Cat. No.
001.67.751

**Packing:** 1 set

## DBB MORTICE JIG - SCREW ON VERSION



## LONG DRILL BIT Ø10 MM

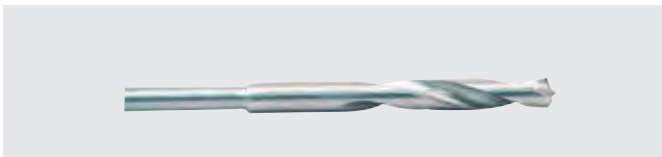

- > To drill through full width of door for electric cables etc.

Length (mm)	Cat. No.
950	001.67.760
1250	001.67.761

**Packing:** 1 piece

## LONG DRILL ADAPTOR



- > Convert standard housing down to small bore for Long Drill Bits, 001.67.760 & 001.67.761

Cat. No.
001.67.749

**Packing:** 1 piece



## TWIST DRILL BITS



Diameter Ø (mm)	Packing (pieces)	Cat. No.
1.0	10	001.41.006
1.5	10	001.41.015
2.0	10	001.41.024
2.5	10	001.41.042
3.0	10	001.41.051
3.2	10	001.41.079
3.5	10	001.41.088
4.0	10	001.41.104
4.5	10	001.41.131
5.0	10	001.41.168
6.0	10	001.41.186
8.0	10	001.41.248
10.0	1	001.41.293

**Packing:** 1 or 10 pieces

## METAL DRILL BIT SET



Diameter (mm)	Cat. No.
Ø1-10 in 0.5 mm steps	001.41.530

**Packing:** 1 piece

## HM MASONRY DRILL BIT



- > For use with cordless drills, impact drilling: In sand-lime brick plan elements, red bricks and concrete, rotary drilling: In roof tiles, slates, marble, wall tiles and lightweight materials
- > Rapid drilling provided by aggressive hard metal cutting edges, quadruple conveyor spiral for rapid drilling dust extraction
- > Cutting material: HM-tipped

Diameter Ø (mm)	Cat. No.
6.0	001.69.007
8.0	001.69.013
10.0	001.69.015

**Packing:** 1 piece

## TWIST DRILL BIT FOR WOOD



Diameter Ø (mm)	Length (mm)	Cat. No.
5	85	001.20.505
8	110	001.20.508
10	110	001.20.510

**Packing:** 1 piece

## HINGE MACHINE DRILL BIT Ø8MM



	Cat. No.
Left Hand	001.97.437
Right Hand	001.97.428

**Packing:** 1 piece

## HINGE MACHINE DRILL BIT Ø10MM



	Cat. No.
Left Hand	001.97.455
Right Hand	001.97.446

**Packing:** 1 piece

### STOP RING



- > Retaining screw with hexagonal socket

Drill bit diameter Ø (mm)	Length (mm)	Cat. No.
5	10	001.42.665
8	16	001.42.683
10	23	001.42.693

**Packing:** 1 piece

### HINGE MACHINE DRILL BIT Ø35MM



	Cat. No.
Right Hand	001.97.508

**Packing:** 1 piece

### COUNTERSINK DRILL BIT WITH DEPTH GAUGE



- > Drilling and countersinking in one operation prevents tearing of screws in hardwood
- > Drill bit: Ø4.8 mm

	Cat. No.
	001.28.590

**Packing:** 1 piece

### PLUG ON COUNTERSINK DRILL BIT



- > For use on a drill bit, with retaining screw

Diameter Ø (mm)	Cat. No.
4.0	001.28.218
5.0	001.28.227

**Packing:** 1 piece

### HAND HELD COUNTERSINK BIT



	Cat. No.
	001.26.134

**Packing:** 1 piece

### HÄFELE PZ BITS



- > With Häfele lettering
- > Length: 25 mm
- > Drive: 1/4"

### HÄFELE PZ TORSION BITS



- > With Häfele lettering, for use when drilling into soft material, long life time, low wear, less contact pressure required, extra hard
- > Length: 50 mm
- > Drive: 1/4"

### HÄFELE PH BITS



- > With Häfele lettering, for sheet metal screws
- > Length: 25 mm
- > Drive: 1/4"

Size	Screw Ø (mm)	Cat. No.
PZ1	3	006.37.121
PZ2	3.5-5	006.37.122
PZ3	6	006.37.123

**Packing:** 10 pieces

Size	Screw Ø (mm)	Cat. No.
PZ1	3	006.37.231
PZ2	3.5-5	006.37.232
PZ3	6	006.37.233

**Packing:** 10 pieces

Size	Screw Ø (mm)	Cat. No.
PH1	2.2-2.9	006.37.101
PH2	3.5-4.8	006.37.102
PH3	5.5-6.3	006.37.103

**Packing:** 10 pieces

### HÄFELE T-STAR DRIVE BIT



- > With Häfele lettering
- > Length: 25 mm
- > Drive: 1/4"

### STANDARD BIT FOR PHILLIPS DRIVE



- > Length: 50 mm

Size	Cat. No.
TS20	006.37.143

**Packing:** 10 pieces

Size	Screw Ø (mm)	Cat. No.
PH2	3.5-5.0	006.40.281

**Packing:** 10 pieces

## CONSUMABLES & TOOLS

### DRILL BITS, SCREW BITS & JIGSAW BLADES

#### HÄFELE PZ AND PH BIT BOX WITH 10 BITS



- > Supplied with: 1 universal magnetic holder 1 5.5 and 6.5 mm flat bits, 1 PH1 and PH3 bits, 2 PH2 bits, 1 PZ1 and PZ3 bits, 2 PZ2 bits

	Cat. No.
	006.37.090

**Packing:** 1 piece

#### HÄFELE PZ AND TS BIT BOX WITH 10 BITS



- > Supplied with: 1 universal magnetic holder, 1 PZ1 and PZ3 bits, 2 PZ2 bits, 1 TS10, TS15 TS20 TS25 TS30 TS40 bits

	Cat. No.
	006.37.093

**Packing:** 1 piece

#### HÄFELE PZ BIT BOX WITH 10 BITS



- > Extra hard HOT torsion bit
- > Supplied with: 1 universal magnetic holder, 2 PZ1 and PZ3 bits, 6 PZ2 bits

	Cat. No.
	006.37.095

**Packing:** 1 piece

#### UNIVERSAL MAGNETIC HOLDER WITH QUICK RELEASE



- > With permanent magnet
- > Length: 60 mm
- > Drive: 1/4"
- > Bit socket: 1/4"

	Cat. No.
	006.37.250

**Packing:** 1 piece

#### OFFSET SCREWDRIVER

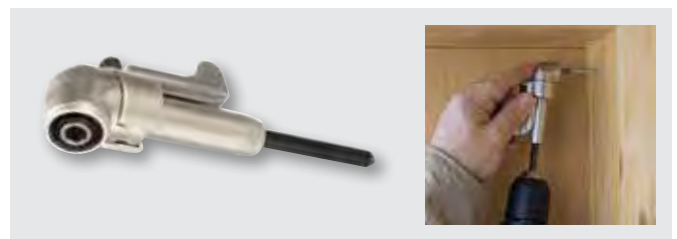

- > Screw down to the last angle, magnetic
- > For all 1/4" bits and countersinker

	Cat. No.
	006.40.805

**Packing:** 1 piece

#### JIGSAW BLADE - MULTI BOX



- > For wood materials, for almost all applications, pitch 1.6 mm: for straight cuts, extremely suitable for laminate, pitch 2.5 mm: for straight, fine cuts, pitch 4 mm: extra strong blade for long and straight cuts, progressive pitch 4-5.2 mm, progressive pitch 4-5.2 mm: for softwood and boards, especially for cutting curves
- > 5 each of 5 different jigsaw blades

	Cat. No.
	000.70.302

**Packing:** 1 pack

#### JIGSAW BLADE FOR METAL



- > Steel, non-ferrous metals, up to 2 mm, HCS steel, wavy set tooth design
- > Pitch: 1.2 mm
- > Toothed length: 50 mm

	Cat. No.
	000.70.369

**Packing:** 1 pack (5 pieces)

**JIGSAW BLADES FOR WOOD MATERIALS**



- > For quick cuts in softwood, chipboard, plywood, fibreboard, from 5 - 50 mm, HCS steel, side set tooth design
- > Pitch: 4 mm
- > Toothed length: 105 mm

	Cat. No.
	000.70.403

**Packing:** 1 pack (5 pieces)

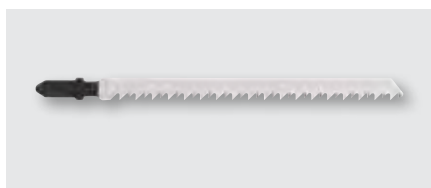

- > For quick cutting in hardwood and softwood, coated panels, chipboard and plywood, plastics, from 5 - 70 mm, HCS steel, taper ground
- > Pitch: 3 mm
- > Toothed length: 105 mm

	Cat. No.
	000.70.402

**Packing:** 1 pack (5 pieces)



- > For quick cutting in hardwood and softwood, HCS steel, side set tooth design
- > Pitch: 4 mm
- > Toothed length: 75 mm

	Cat. No.
	000.70.349

**Packing:** 1 pack (5 pieces)



- > For fast, clean, right-angled cuts in hardwood and softwood, plywood, coated chipboard, plastics, up to 60mm, HCS steel, taper ground
- > Pitch: 2.5 mm
- > Toothed length: 91 mm

	Cat. No.
	000.70.401

**Packing:** 1 pack (5 pieces)



- > For neat surface cut in wood, laminate, parquet, plywood, plastics, coated wood, up to 20 mm, Bi-metal, taper ground, reverse ground teeth
- > Pitch: 1.9 mm
- > Toothed length: 60 mm

	Cat. No.
	000.70.405

**Packing:** 1 pack (5 pieces)



- > For clean cuts in hardwood, wood materials, plastics, HCS steel, taper ground
- > Pitch: 2.5 mm
- > Toothed length: 75 mm

	Cat. No.
	000.70.319

**Packing:** 1 pack (5 pieces)



- > Specially for curved cuts in softwood, chipboard, plywood, fibreboard, from 5 - 50 mm, HCS steel, ground, side set tooth design
- > Pitch: 4 mm
- > Toothed length: 75 mm

	Cat. No.
	000.70.400

**Packing:** 1 pack (5 pieces)



- > For clean cuts in hardwood and softwood, plastics, HCS steel, taper ground
- > Pitch: 4 mm
- > Toothed length: 75 mm

	Cat. No.
	000.70.329

**Packing:** 1 pack (5 pieces)



- > For fast, clean, right-angled cuts in hardwood and softwood, plywood, coated chipboard, plastics, up to 60 mm, HCS steel, taper ground
- > Pitch: 2.5 mm
- > Toothed length: 91 mm

	Cat. No.
	000.70.301

**Packing:** 1 pack (25 pieces)



## HOSPA POZIDRIVE COUNTERSUNK SCREWS

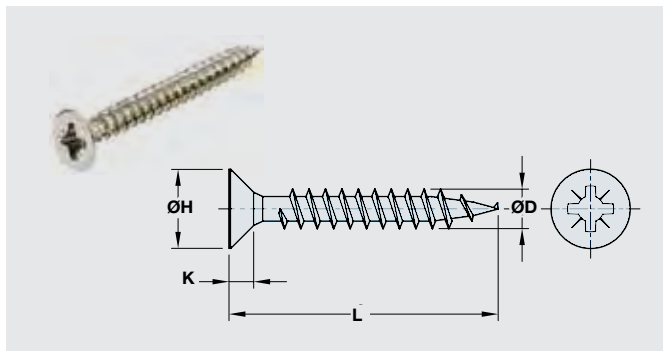

- > Material: steel, galvanised
- > Drive: cross recess, PZ
- > Thread: fully threaded

Thread ØD (mm)	Head ØH (mm)	Head height K (mm)	Drive
2.5	5.0	1.6	PZ1
3.0	6.0	1.8	PZ1
3.5	7.0	2.1	PZ2
4.0	8.0	2.4	PZ2
4.5	9.0	2.7	PZ2
5.0	10.0	2.9	PZ2

Dimensions D x L (mm)	Packing (pieces)	Cat. No.
<b>Orga-Box</b>		
2.5 x 16	1000	015.31.255
3.0 x 13	1000	015.31.522
3.0 x 15	1000	015.31.531
3.0 x 17	1000	015.31.540
3.0 x 20	1000	015.31.559
3.0 x 25	1000	015.31.577
3.0 x 30	1000	015.31.586
3.0 x 35	1000	015.31.595
3.0 x 40	1000	015.31.602
3.5 x 13	1000	015.31.620
3.5 x 15	1000	015.31.639
3.5 x 17	1000	015.31.648
3.5 x 20	1000	015.31.657
3.5 x 25	1000	015.31.675
3.5 x 30	1000	015.31.684
3.5 x 35	1000	015.31.693
3.5 x 40	500	015.31.700
3.5 x 45	500	015.31.719
3.5 x 50	500	015.31.728
4.0 x 13	1000	015.31.824
4.0 x 15	1000	015.31.826
4.0 x 17	1000	015.31.835
4.0 x 20	1000	015.31.844
4.0 x 25	1000	015.31.853
4.0 x 30	1000	015.31.862
4.0 x 35	500	015.31.871
4.0 x 40	500	015.31.880
4.0 x 45	500	015.31.899
4.0 x 50	500	015.31.906
4.0 x 55	200	015.31.808
4.5 x 17	1000	015.31.915
4.5 x 20	1000	015.31.924

Dimensions D x L (mm)	Packing (pieces)	Cat. No.
4.5 x 25	1000	015.31.933
4.5 x 30	1000	015.31.942
4.5 x 35	500	015.31.951
4.5 x 40	500	015.31.960
4.5 x 45	500	015.31.979
4.5 x 50	200	015.31.988
4.5 x 55	200	015.32.010
5.0 x 20	1000	015.32.074
5.0 x 25	1000	015.32.083
5.0 x 30	500	015.32.092
5.0 x 35	500	015.32.109
5.0 x 40	500	015.32.118
5.0 x 45	200	015.32.127
5.0 x 50	200	015.31.997
5.0 x 55	200	015.32.136
5.0 x 75	1000	015.46.193

<b>Big-Pack</b>		
3.5 x 15	10000	017.31.639
3.5 x 17	10000	017.31.648
3.5 x 30	8000	017.31.684
3.5 x 40	5000	017.31.700
3.5 x 50	5000	017.31.728
4.0 x 15	8000	017.31.826
4.0 x 17	8000	017.31.835
4.0 x 25	8000	017.31.853
4.0 x 30	5000	017.31.862
4.0 x 28	5000	017.31.782
4.0 x 35	5000	017.31.871
4.0 x 40	4000	017.31.880
4.0 x 45	3000	017.31.899
4.0 x 50	3000	017.31.906
4.5 x 30	5000	017.31.942
4.5 x 50	2000	017.31.988

HOSPA POZIDRIVE COUNTERSUNK SCREWS WITH  
CENTRAL HOLE FOR CAP FIXING

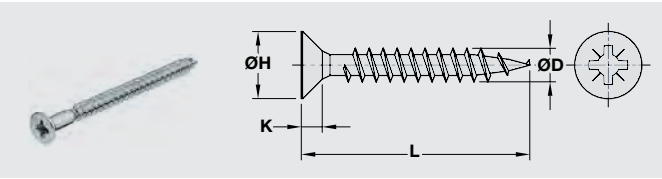

- > Material: steel, galvanised
- > Drive: cross recess, PZ
- > Thread: partially threaded
- > With central hole 2.5 mm

Thread ØD (mm)	Head ØH (mm)	Drive
4.5	9.0	PZ2

Dimensions D x L (mm)	Packing (pieces)	Cat. No.
-----------------------	------------------	----------

Orga-Box

4.5 x 28	1000	015.01.926
4.5 x 30	1000	015.01.944
4.5 x 35	500	015.01.953
4.5 x 40	500	015.01.962
4.5 x 45	500	015.01.971
4.5 x 50	200	015.01.980

Big-Pack

4.5 x 28	5000	017.01.926
4.5 x 30	5000	017.01.944
4.5 x 35	3000	017.01.953
4.5 x 40	3000	017.01.962
4.5 x 45	3000	017.01.971
4.5 x 50	2000	017.01.980
4.5 x 60	2000	017.02.003
4.5 x 65	2000	017.02.012
4.5 x 70	2000	017.02.021

HOSPA POZIDRIVE COUNTERSUNK SCREWS

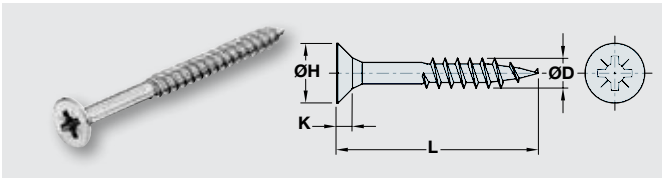

- > Material: steel, galvanised
- > Drive: cross recess, PZ
- > Thread: partially threaded

Thread ØD (mm)	Head ØH (mm)	Head height K (mm)	Drive
4.0	8.0	2.4	PZ2
4.5	9.0	2.7	PZ2
5.0	10.0	2.9	PZ3

Dimensions D x L (mm)	Packing (pieces)	Cat. No.
-----------------------	------------------	----------

Orga-Box

4.0 x 35	500	015.41.877
4.0 x 50	500	015.41.902
4.5 x 40	500	015.41.966
4.5 x 70	200	015.42.034
4.5 x 80	200	015.42.043
5.0 x 70	200	015.42.169

HOSPA POZIDRIVE COUNTERSUNK SCREWS,  
WITH NIBS

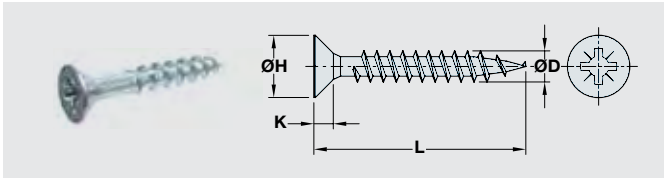

- > Material: steel, galvanised
- > Type of head: countersunk with nibs
- > Drive: cross recess PZ
- > Thread: Partially threaded

Thread ØD (mm)	Head ØH (mm)	Head height K (mm)	Drive
4.2	7.5	3.8	PZ1

Dimensions D x L (mm)	Packing (pieces)	Cat. No.
<b>Orga-Box</b>		
4.2 x 28	1000	015.95.120
4.2 x 30	1000	015.95.121
4.2 x 35	500	015.95.123
4.2 x 40	500	015.95.124
4.2 x 45	500	015.95.125
4.2 x 50	500	015.95.126
<b>Big-Pack</b>		
4.2 x 40	3000	015.95.714
4.2 x 45	3000	015.95.715
4.2 x 50	2000	015.95.716

HOSPA POZIDRIVE COUNTERSUNK SCREWS,  
WITH NIBS AND CENTRAL HOLE FOR CAP FIXING

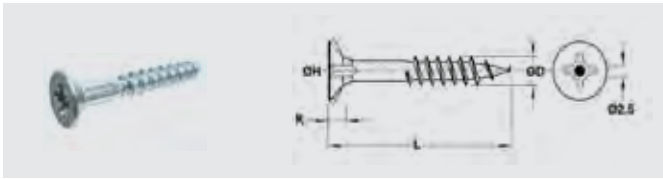

- > Material: steel, galvanised
- > Type of head: countersunk with nibs and central hole
- > Drive: cross recess PZ
- > Thread: Partially threaded/fine thread
- > Central hole: Ø2.5 mm head hole

Thread ØD (mm)	Head ØH (mm)	Head height K (mm)	Drive
4.5	8.5	3.0	PZ2

Dimensions D x L (mm)	Packing (pieces)	Cat. No.
<b>Orga-Box</b>		
4.5 x 28	1000	015.96.450
4.5 x 30	1000	015.96.451
4.5 x 40	500	015.96.454
4.5 x 45	500	015.96.455
4.5 x 60	200	015.96.458
<b>Big-Pack</b>		
4.5 x 28	5000	015.96.810
4.5 x 30	3000	015.96.811
4.5 x 40	3000	015.96.814
4.5 x 50	2000	015.96.816
4.5 x 60	2000	015.96.818
4.5 x 75	2000	015.96.821

HOSPA POZIDRIVE PAN HEAD SCREWS

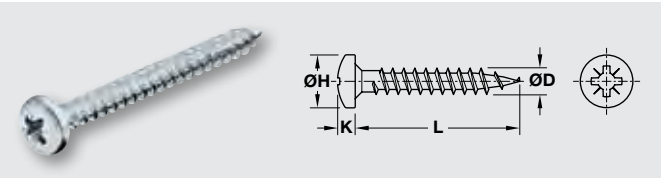

- > Material: steel, galvanised
- > Thread: fully threaded
- > Drive: cross recess, PZ

Thread ØD (mm)	Head ØH (mm)	Head height K (mm)	Drive
3.0	6.0	2.4	PZ1
3.5	7.0	2.5	PZ2
4.0	8.0	2.9	PZ2
4.5	9.0	3.2	PZ2
5.0	10.0	3.5	PZ2

Dimensions D x L (mm)	Packing (pieces)	Cat. No.
<b>Orga-Box</b>		
3.0 x 13	1000	015.71.526
3.0 x 17	1000	015.71.544
3.5 x 13	1000	015.71.624
3.5 x 15	1000	015.71.633
3.5 x 20	1000	015.71.651
4.0 x 13	1000	015.71.811
4.0 x 15	1000	015.71.820
4.0 x 17	1000	015.71.839
4.0 x 20	1000	015.71.848
4.0 x 25	1000	015.71.857
4.0 x 40	500	015.71.884
4.5 x 15	1000	015.71.919
4.5 x 17	1000	015.71.991
4.5 x 20	1000	015.71.928
4.5 x 25	1000	015.71.937
4.5 x 30	500	015.71.946
5.0 x 20	1000	015.72.078

HOSPA POZIDRIVE RAISED HEAD COUNTERSUNK SCREWS

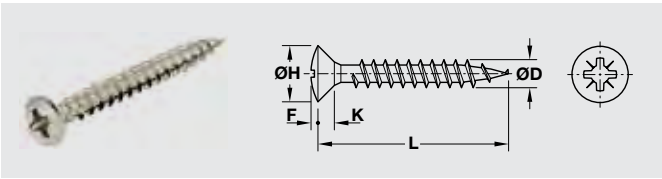

- > Material: steel, nickel plated
- > Thread: fully threaded
- > Drive: cross recess, PZ

Thread ØD (mm)	Head ØH (mm)	Head height K (mm)	Head size F (mm)	Drive
3.5	7.0	2.1	1.0	PZ2

Dimensions D x L (mm)	Packing (pieces)	Cat. No.
<b>Orga-Box</b>		
3.5 x 15	1000	015.55.639

HOSPA POZIDRIVE COUNTERSUNK SCREWS

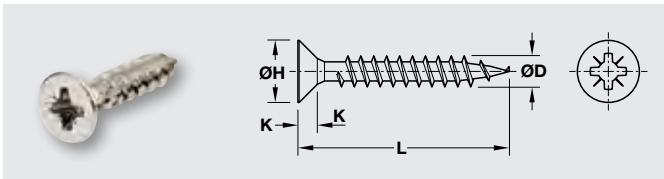

- > Material: steel, nickel plated
- > Thread: fully threaded

Thread ØD (mm)	Head ØH (mm)	Head height K (mm)	Drive
2.5	5.0	1.6	PZ1
3.0	5.0	1.8	PZ1
3.5	7.0	2.1	PZ2
4.0	8.0	2.4	PZ2

Dimensions D x L (mm)	Packing (pieces)	Cat. No.
<b>Orga-Box</b>		
2.5 x 16	1000	015.35.253
3.0 x 15	1000	015.35.333
3.5 x 15	1000	015.35.637
3.5 x 17	1000	015.35.646
4.0 x 15	1000	015.35.824
4.0 x 17	1000	015.35.833

HOSPA POZIDRIVE COUNTERSUNK SCREWS

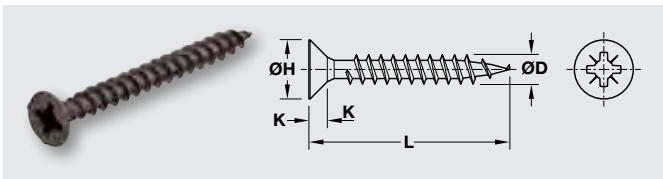

- > Material: steel, black galvanised
- > Thread: fully threaded
- > Drive: cross recess, PZ

Thread ØD (mm)	Head ØH (mm)	Head height K (mm)	Drive
3.5	7.0	2.1	PZ2

Dimensions D x L (mm)	Packing (pieces)	Cat. No.
<b>Orga-Box</b>		
3.5 x 16	1000	015.39.648



HOSPA POZIDRIVE COUNTERSUNK SCREWS

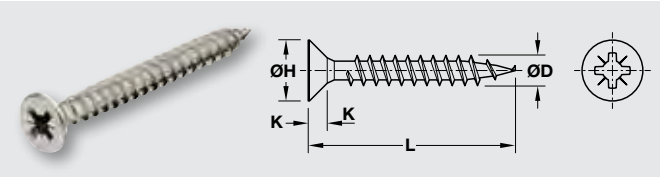

- > Material: stainless steel
- > Thread: fully threaded
- > Drive: cross recess, PZ

Thread ØD (mm)	Head ØH (mm)	Head height K (mm)	Drive
3.0	6.0	1.5	PZ1

Dimensions D x L (mm)	Packing (pieces)	Cat. No.
<b>Orga-Box</b>		
3.0 x 16	500	014.70.542
3.0 x 20	500	014.70.551

HOSPA POZIDRIVE FLAT HEAD REAR PANEL SCREWS

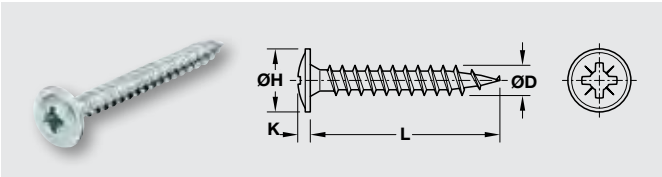

- > Material: steel, galvanised
- > Thread: fully threaded
- > Drive: cross recess, PZ

Thread ØD (mm)	Head ØH (mm)	Head height K (mm)	Drive
4.0	9.5	1.9	PZ2

Dimensions D x L (mm)	Packing (pieces)	Cat. No.
<b>Orga-Box</b>		
4.0 x 20	1000	016.10.840
4.0 x 25	1000	016.10.859
4.0 x 30	1000	016.10.868

## VARIANTA COUNTERSUNK HEAD POZIDRIVE SCREWS

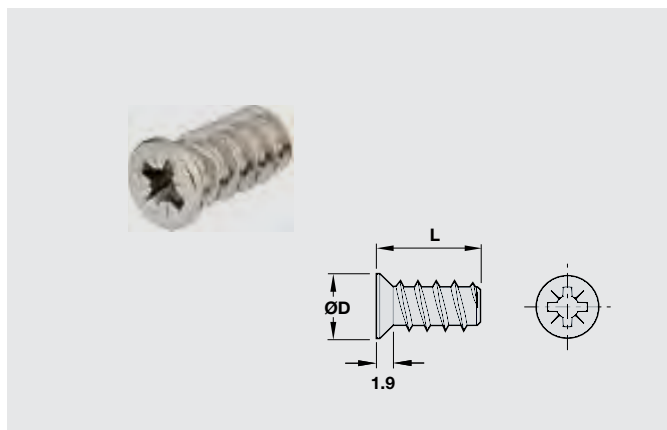

- > Material: steel, nickel plated
- > Thread: fully threaded
- > Drive: cross recess, PZ
- > For drilling into Ø5 mm wood

Thread ØD (mm)	Pitch (mm)	Body Ø (mm)	Drive
6.2	2.2	4.6	PZ2

Length L (mm)	Packing (pieces)	Cat. No.
<b>Orga-Box</b>		
10.5	100	013.15.715
13.5	100	013.15.724
16.0	100	013.15.733

## VARIANTA COUNTERSUNK POZIDRIVE SCREWS

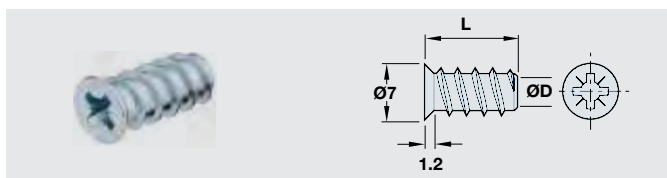

- > Material: steel, galvanised
- > Thread: fully threaded
- > Drive: cross recess, PZ
- > For drill hole Ø5 mm in wood

Thread ØD (mm)	Pitch (mm)	Body Ø (mm)	Drive
6.0	2.2	4.6	PZ2

Length L (mm)	Packing (pieces)	Cat. No.
<b>Orga-Box</b>		
8.0	100	013.14.908
10.5	100	013.14.910
13.5	100	013.14.920

<b>Big-Pack</b>		
10.5	5000	012.14.910
13.5	5000	012.14.920

## VARIANTA CYLINDRICAL HEAD SCREWS

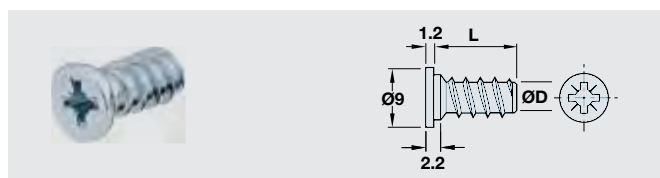

- > Material: steel
- > Thread: fully threaded
- > Drive: cross recess, PZ
- > For drill hole Ø5 mm in wood

Thread ØD (mm)	Pitch (mm)	Body Ø (mm)	Drive
6.0	2.2	4.6	PZ2

Length L (mm)	Finish	Packing (pieces)	Cat. No.
<b>Orga-Box</b>			
10.5	Nickel plated	100	013.20.716
16.0	Galvanised	100	013.20.949

## HOSPA PHILLIPS HEAD COUNTERSUNK SCREWS

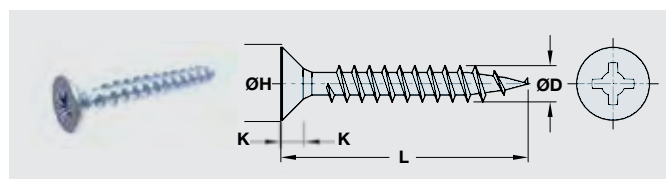

- > Material: steel, galvanised
- > Type of head: countersunk
- > Drive: PH1 (3.0), PH2 (3.5, 4.0)
- > Thread: fully threaded/ fine thread

## HOSPA PHILLIPS HEAD COUNTERSUNK SCREWS WITH NIBS

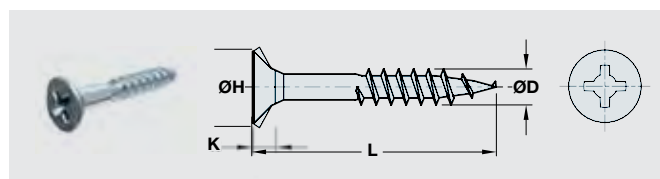

- > Material: steel, galvanised
- > Type of head: countersunk, with nibs
- > Drive: cross threaded PH2
- > Thread: partially threaded/ deep coarse thread

Thread ØD (mm)	Head ØH (mm)	Head height K (mm)	Drive
3.0	5.5	1.6	PH1
3.5	6.5	1.9	PH2
4.0	8.0	2.3	PH2

Dimensions D x L (mm)	Packing (pieces)	Cat. No.
<b>Orga-Box</b>		
3.0 x 15	1000	015.90.053
3.0 x 17	1000	015.90.055
3.5 x 13	1000	015.90.080
3.5 x 15	1000	015.90.081
3.5 x 17	1000	015.90.085
3.5 x 20	1000	015.90.086
3.5 x 25	1000	015.90.089
4.0 x 15	1000	015.90.113
4.0 x 17	1000	015.90.115
4.0 x 20	1000	015.90.116
4.0 x 25	1000	015.90.119
4.0 x 28	1000	015.90.121
4.0 x 30	1000	015.90.120
4.0 x 32	1000	015.90.122
4.0 x 35	1000	015.90.123
4.0 x 40	500	015.90.124
4.0 x 45	500	015.90.125
4.0 x 50	500	015.90.126
4.0 x 62	500	015.90.128
<b>Big-Pack</b>		
3.5 x 15	10000	015.90.543
3.5 x 17	10000	015.90.545
4.0 x 15	8000	015.90.573
4.0 x 28	5000	015.90.580
4.0 x 30	5000	015.90.581
4.0 x 40	4000	015.90.584
4.0 x 45	3000	015.90.585
4.0 x 50	3000	015.90.586

Thread ØD (mm)	Head ØH (mm)	Head height K (mm)	Drive
3.5	6.5	3.2	PH2
4.2	8.0	3.6	PH2
5.0	9.0	4.0	PH2

Dimensions D x L (mm)	Packing (pieces)	Cat. No.
<b>Orga-Box</b>		
3.5 x 38	1000	015.91.094
4.2 x 16	1000	015.91.115
4.2 x 19	1000	015.91.116
4.2 x 25	1000	015.91.119
4.2 x 29	1000	015.91.121
4.2 x 32	1000	015.91.122
4.2 x 39	500	015.91.123
4.2 x 41	500	015.91.124
4.2 x 44	500	015.91.125
4.2 x 51	500	015.91.126
4.2 x 57	500	015.91.128
4.2 x 64	500	015.91.129
4.2 x 76	200	015.91.131
<b>Big-Pack</b>		
4.2 x 25	5000	015.91.579
4.2 x 29	5000	015.91.581
4.2 x 32	5000	015.91.582
4.2 x 39	5000	015.91.584
4.2 x 41	4000	015.91.585
4.2 x 44	3000	015.91.586
4.2 x 51	3000	015.91.587
4.2 x 64	2000	015.91.589
5.0 x 75	1000	015.46.192

## HOSPA PHILLIPS HEAD COUNTERSUNK SCREWS

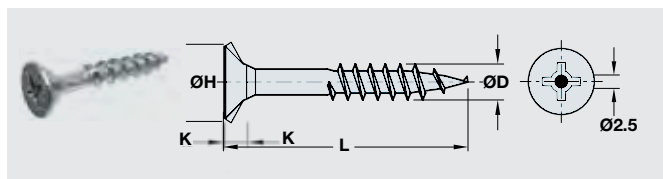

- > Material: steel, galvanised
- > Type of head: countersunk with nibs and central hole
- > Drive: cross recess PH2
- > Thread: partially threaded/ fine thread
- > Central hole: Ø 2.5 mm head

Thread ØD (mm)	Head ØH (mm)	Head height K (mm)	Drive
4.5	9.0	2.9	PH2

Dimensions D x L (mm)	Packing (pieces)	Cat. No.
<b>Orga-Box</b>		
4.5 x 25	1000	015.92.449
4.5 x 28	1000	015.92.450
4.5 x 30	1000	015.92.451
4.5 x 35	1000	015.92.453
4.5 x 40	500	015.92.454
4.5 x 45	1000	015.92.455
4.5 x 50	200	015.92.456
4.5 x 60	1000	015.92.458
4.5 x 65	200	015.92.459
4.5 x 70	200	015.92.460
4.5 x 75	200	015.92.461
<b>Big-Pack</b>		
4.5 x 28	5000	015.92.810
4.5 x 30	5000	015.92.811
4.5 x 40	3000	015.92.814
4.5 x 50	2000	015.92.816

## HOSPA PHILLIPS HEAD PAN HEAD SCREWS

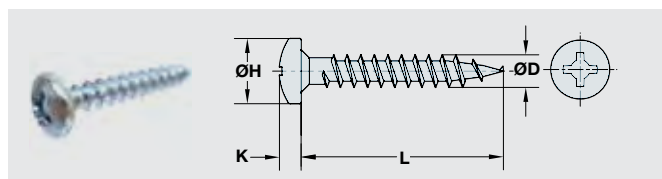

- > Material: steel, galvanised
- > Type of head: pan head
- > Drive: cross recess PH2
- > Thread: fully threaded/ fine thread

Thread ØD (mm)	Head ØH (mm)	Head thickness K (mm)
3.5	6.5	2.5
4.0	8.0	3.0
4.5	9.0	3.0
5.0	9.0	3.5

Dimensions D x L (mm)	Packing (pieces)	Cat. No.
<b>Orga-Box</b>		
3.5 x 13	1000	015.89.082
3.5 x 15	1000	015.89.083
3.5 x 20	1000	015.89.086
4.0 x 15	1000	015.89.113
4.0 x 17	1000	015.89.115
4.5 x 15	1000	015.89.143
5.0 x 20	1000	015.89.176

Dimensions in mm Dimensional data not binding. We reserve the right to alter specifications without notice.

CONFIRMAT ONE-PIECE CONNECTOR

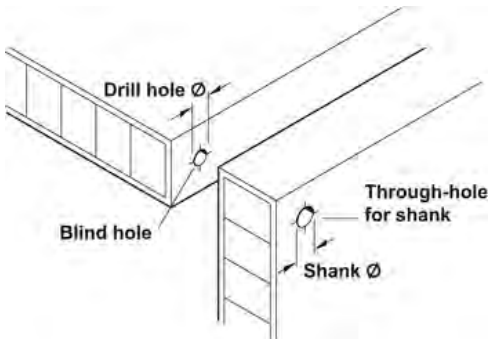

FOR DRILL HOLE Ø4 MM, WITH SHANK Ø5 MM

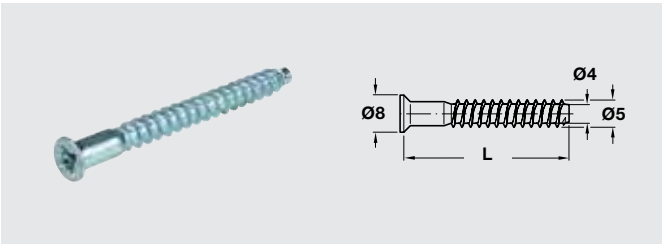

- > Material: steel, galvanised
- > Type of head: countersunk
- > Drive: cross recess, PZ2

Length L (mm)	Cat. No.
50	264.37.196

Packing: 100 or 2000 pieces

FOR DRILL HOLE Ø5 MM, WITH SHANK Ø7 MM

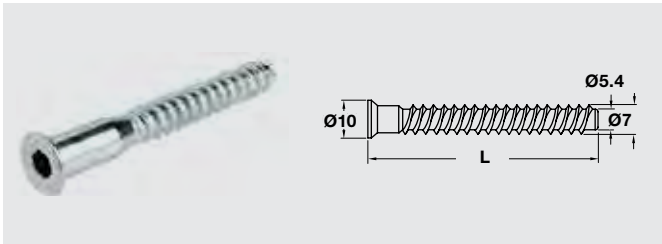

- > Material: steel, galvanised
- > Type of head: countersunk
- > Drive: SW4 hexagon socket

Length L (mm)	Cat. No.
50	264.53.190

Packing: 100 or 1000 pieces

FOR DRILL HOLE Ø5 MM, WITH SHANK Ø6.3 MM

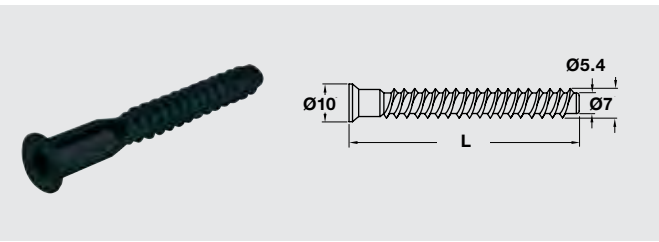

- > Material: steel, black
- > Type of head: countersunk
- > Drive: hex sockets. 4 mm

Length L (mm)	Cat. No.
50	264.43.112

Packing: 100 pieces

FOR DRILL HOLE Ø5 MM, WITH SHANK Ø7 MM

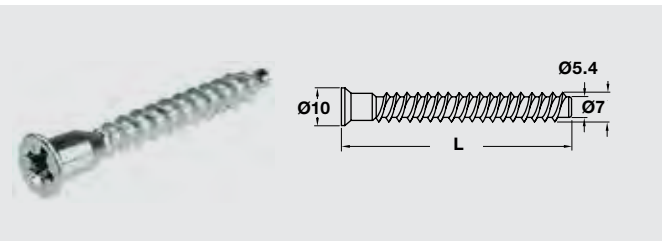

- > Material: steel, galvanised
- > Type of head: countersunk
- > Drive: cross recess, PZ3

Length L (mm)	Cat. No.
50	264.42.190

Packing: 100 or 1000 pieces

## M4 HANDLE SCREWS

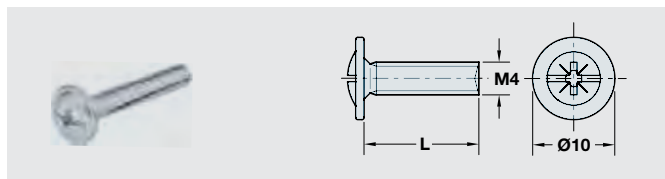

- > For mounting furniture handles and knobs
- > Material: steel, galvanised
- > Type of head: flat head
- > Drive: combi cross/ slot recess
- > Thread: M4

Length L (mm)	Packing (pieces)	Cat. No.
<b>Orga-Box</b>		
8	100	022.35.081
10	100	022.35.109
12	100	022.35.127
15	100	022.35.154
18	100	022.35.181
20	100	022.35.207
22	100	022.35.225
23	100	022.35.234
24	100	022.35.243
25	100	022.35.252
28	100	022.35.289
30	100	022.35.305
32	100	022.35.323
35	100	022.35.350
38	100	022.35.387
40	100	022.35.403
45	100	022.35.458
50	100	022.35.501
60	100	022.35.609
<b>Big-Pack</b>		
20	5000	022.45.207
22	5000	022.45.225
25	5000	022.45.252
40	3000	022.45.403

## BREAK-OFF HANDLE SCREWS

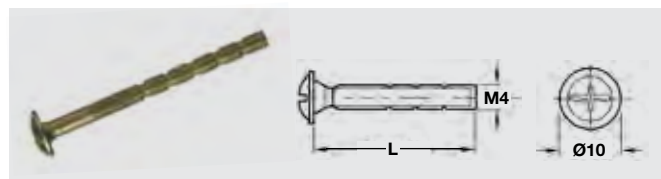

- > Material: steel, galvanised
- > Type of head: flat head
- > Thread: M4

Length L (mm)	Cat. No.
45	022.35.887

**Packing:** 100 pieces



## COVER CAPS

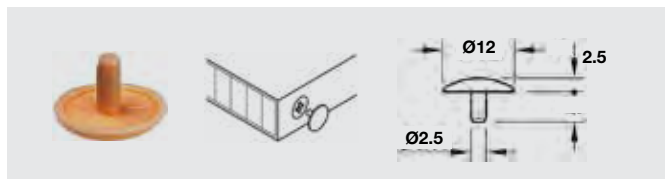

- > For Phillips recess and Pozidrive screws with central hole
- > Material: plastic

Colour	Packing (pieces)	Cat. No.
Pure white, RAL 9010	1000	045.04.705
Light grey, RAL 7035	500	045.04.509
Pine coloured, RAL 1002	1000	045.04.009
Ivory, RAL 1015	1000	045.04.410
Fawn brown, RAL 8007	500	045.04.107
Stone grey, RAL 7032	1000	045.04.518
Black, RAL 9005	1000	045.04.303

## COVER CAPS

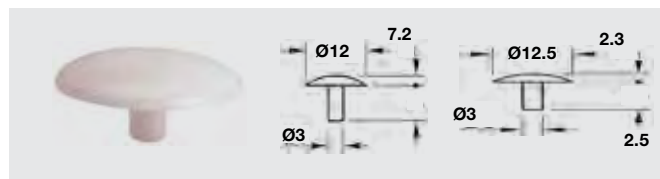

- > Material: plastic

Diameter (mm)	Colour	Cat. No.
<b>PZ3 cross slot</b>		
Ø12	White	045.01.704
	Black	045.01.302
<b>SW4 hexagon socket</b>		
Ø12.5	White	045.01.731

**Packing:** 100 pieces

## SELF ADHESIVE WOOD VENEER COVER CAPS

### Unfinished

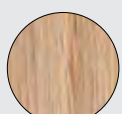

white oak

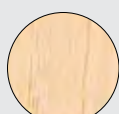

ash

### Finished



birch

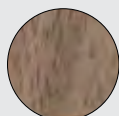

walnut

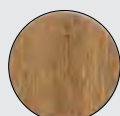

teak

### Ø14 mm Application

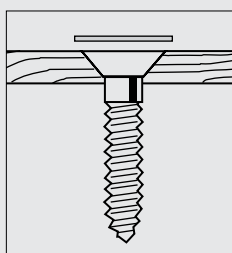

### Ø18 mm Application

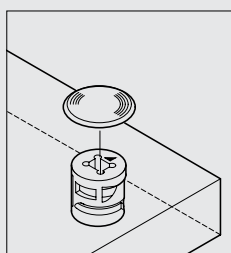

- > No caulking or extra glue needed. Wood can be sanded, stained and finished to match hard and soft wood case products. Can be cut to fit same texture, colour and appearance of industry wood materials. Does not depend on screw for proper installation, easy to apply, provides durable, attractive coverage
- > Material: made of real wood
- > Thickness: 0.90 mm
- > Temperature resistance: 40°C - 121°C
- > Application temperature: 12.5°C

Finish	Ø14 (mm)	Ø18 (mm)
<b>Unfinished</b>		
White oak	045.24.400	045.26.400
Ash	045.24.500	045.26.500
<b>Finished</b>		
Birch	–	045.26.801
Walnut	–	045.26.701
Teak	045.24.901	–

**Packing:** Ø14 mm: 1040 caps per box  
Ø18 mm: 720 caps per box

- > Supplied with: 1 sheet of White oak, Ash, Pine, Mahogany, Walnut, Cherry, Hickory, Sapele and Teak

	Cat. No.
Wood veneer sample box (unfinished)	045.24.990

**Packing:** 1 pack

### Note:

Minimum quantities and lead times will apply. Other finishes are available upon request as non-stock items.

## SELF ADHESIVE POLYVINYL (PSA) COVER CAPS



white

antique white

almond

black



light grey

dark grey

### Printed woodgrain

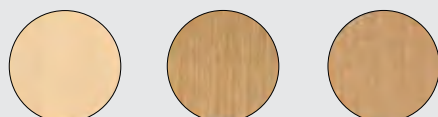

manitoba maple

light maple

american maple

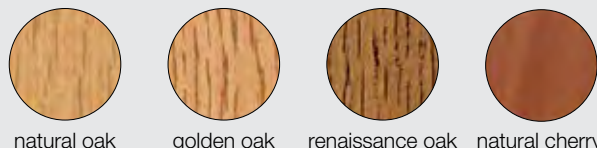

natural oak

golden oak

renaissance oak

natural cherry

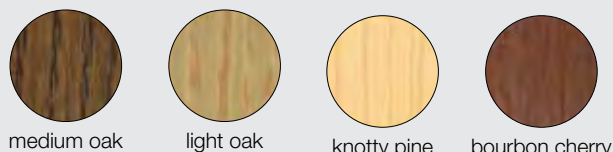

medium oak

light oak

knotty pine

bourbon cherry

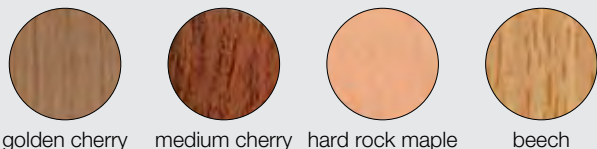

golden cherry

medium cherry

hard rock maple

beech

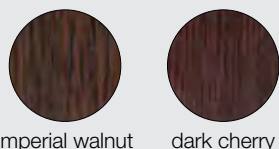

imperial walnut

dark cherry

### Ø14 mm Application

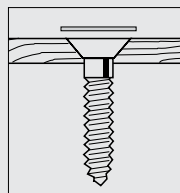

### Ø18 mm Application

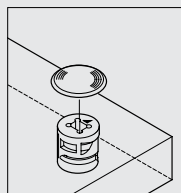

- > No caulking or extra glue needed. Can be cut to fit, same texture, colour and appearance of industry standard sheet goods, does not depend on screw for proper installation, provides durable, attractive coverage
- > Material: Tough polyvinyl (PSA)
- > Thickness: 0.90 mm
- > Temperature resistance: -40°C - +121°C
- > Application temperature: 12.5°C

Finish	Ø14 (mm)	Ø18 (mm)
<b>Solid colours</b>		
White	045.23.700	045.25.700
Antique white	045.23.710	045.25.710
Almond	045.23.400	-
Black	045.23.300	045.25.300
Light grey	045.23.500	045.25.500
Dark grey	045.23.510	045.25.510

<b>Printed woodgrain</b>		
Manitoba maple	045.23.110	-
Light Maple	045.23.112	045.25.112
American maple	045.23.114	-
Natural oak	045.23.410	045.25.410
Golden oak	045.23.411	-
Renaissance oak	045.23.412	-
Medium oak	045.23.415	-
Light oak	045.23.416	045.25.416
Natural cherry	045.23.610	045.25.610
Medium cherry	045.23.611	-
Bourbon cherry	045.23.613	-
Golden cherry	045.23.614	-
Dark cherry	045.23.615	-
Knotty pine	045.23.010	-
Imperial walnut	045.23.702	045.25.702
Beech	045.23.310	045.25.310
Hard rock maple	045.24.110	045.26.110

**Packing:** Ø14 mm: 1040 caps per box  
Ø18 mm: 720 caps per box

	Cat. No.
PSA Sample box (Ø14 mm)	045.24.990

**Packing:** 1 pack (contains 1 sheet of each PSA cap listed)

SELF ADHESIVE POLYVINYL (PSA) COVER CAPS TO MATCH SELECTED POLYTEC COLOURS

Solid colours



Printed woodgrain



Finish	Ø14 (mm)
<b>Solid colours</b>	
Ultra white	045.23.743
Polar white	045.23.744
Canterbury grey	045.23.783
Stone grey	045.23.788
Venette cinder	045.23.789
White	045.23.700
Antique white	045.23.710
Greige	045.52.500
Marina grey	045.52.501
Almond	045.23.400
Classic white gloss	045.52.700
Porcelain	045.52.701
Black	045.23.300
Cinder matt	045.23.522
Ultra white matt	045.23.302
Canterbury grey matt	045.23.303
Oxford matt	045.23.304
Black matt	045.23.305
<b>Printed woodgrain</b>	
Tasmanian oak	045.23.748
Estella oak	045.23.749
Antico oak	045.23.780
Coastal oak	045.23.781
Grey cement	045.23.782
Rocco lini	045.23.506
Rocco lini matt	045.23.742
Notalo walnut	045.23.741
Bleached walnut	045.24.251
Shannon oak	045.52.502
Gesso lini	045.23.507
Soft walnut	045.24.250
Marni lini	045.23.505
Natural oak	045.24.450
Cafe oak	045.24.451
Char oak	045.24.452
Drifted oak	045.24.453
Maison oak	045.24.454
Prime oak	045.24.021
Sepia oak	045.24.455
Tessuto milan	045.24.551
Satra wood	045.24.650
Black wenge	045.24.750
Truffe lini	045.52.100
Crema lini	045.52.400

Packing: 1000 caps per box

CUSTOM COLOUR PUNCH KIT



- > Make your own custom colour cover caps
- > Supplied with: FlushMount DrillBit™ system with 9/16" (14.28 mm) carbide cutter, hard shell case, 3/8" (9.52 mm), 9/16" (14.28 mm), 18 mm dies, Hole Punch Tool™, Sample PowerHead Screws™, 12 x 1270 mm SpeedTape™

	Cat. No.
	001.32.770

Packing: 1 kit



1. Apply SpeedTape to back of the edging that you are going to use to match the board.



2. Punch out the number of caps that you require.



3. Remove backing of the tape from the cap you have punched out and then stick cap in place.

CUTTER DIE

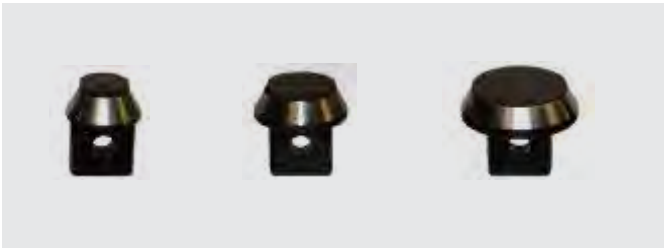

Diameter Ø (mm)	Cat. No.
9	001.32.775
14	001.32.773
18	001.32.774

Packing: 1 piece

EJECTION PIN



	Cat. No.
	001.32.777

Packing: 1 piece

SPEED TAPE



- > High performance ultra-bond adhesive in a peel and stick roll. Apply SpeedTape to almost anything you want to stick in place. Peel off the liner and stick it
- > Great for edgebanding/laminates, jigs and templates and general adhesives
- > Length: 1270 mm

Width (mm)	Cat. No.
15.8	003.58.231
19.0	003.58.232
25.4	003.58.240
228.6	003.58.230

Packing: 1 roll

WATER ACCESS COVERPLATE

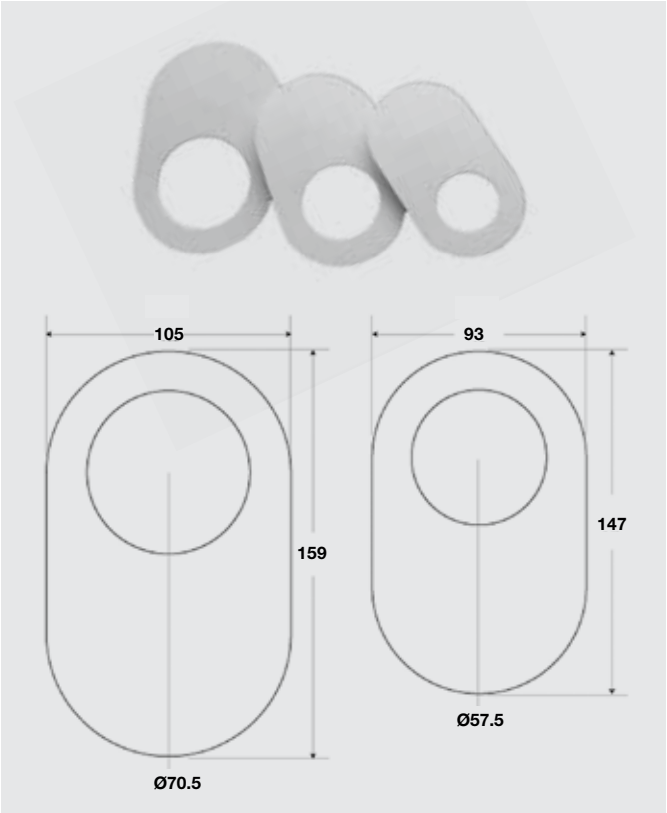

- > Used to tidy plumbing and cable penetrations to kitchen and vanity cabinets, also used to assist installation
- > Material: white gloss plastic with adhesive backing
- > Thickness: 1 mm

Dimensions (mm)	Cat. No.
147 x 93	565.98.991
159 x 105	565.98.992

Packing: 1 piece

CABISEAL™ DISHWASHER INLET/OUTLET HOSE COVER PLATE



- > Cover plate for dishwasher inlet/outlet hoses and power cable
- > 100% Australian made, easy to use self locating design, retrofittable
- > Dimensions (L x W): 150 x 95 mm
- > Material: plastic
- > Colour: white

	Cat. No.
	565.69.997

Packing: 1 or 10 pieces



# HÄFELE

## AXILO™

Meet AXILO™ XL  
All your legs in one.

AXILO™ XL  
Standard height of 120mm with  
-20 and +50mm adjustment.

Try our starter kits today  
including 100 legs and  
adjustment tool. Just ask your  
sales representative or call us.



### Plinth adjusting fitting system.

AXILO™ by Häfele is a new, revolutionary plinth  
adjusting fitting system.

The combination of the adjusting tool and the plinth  
adjusting foot makes levelling a kitchen or a furniture  
item a simple, comfortable operation.



Easy cabinet levelling with just a few manual  
operations.



Ergonomic and back-friendly installation.



Time saving of up to 50% during kitchen  
or furniture assembly.



Large area of application for plinth  
heights from 35 to 220 mm.



OLD WAY

No more bending over, crawling or  
stretching: with AXILO™ you can also  
conveniently access the rear plinth feet.

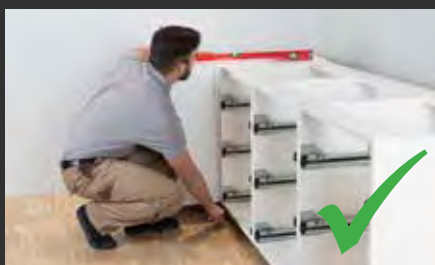

NEW WAY

The AXILO™ adjusting tool can be  
positioned and operated from any angle.  
Practical, particularly in difficult areas.



LONG REACH

The unique AXILO™ adjusting tool acts  
as an extended arm - you can even reach  
plinth feet of corner base units.



TIMBER DOWELS

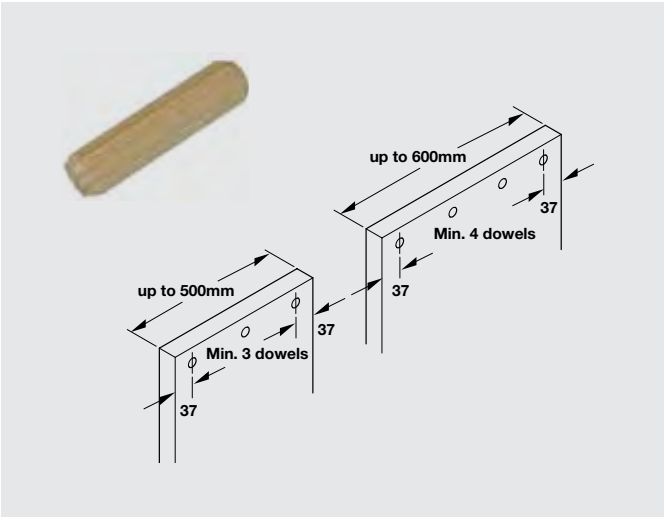

- > These high quality dowels with glue grooves and chamfered ends are made precisely with minor tolerances, manufactured to standard DIN 68150.
- > Particularly suited for automatic dowel inserting machines
- > Material: beech

Diameter Ø (mm)	Length (mm)	Cat. No.
8	30	267.82.230

**Packing:** 10 kg (approx. 10000 pieces)

WOODEN BISCUIT JOINERS

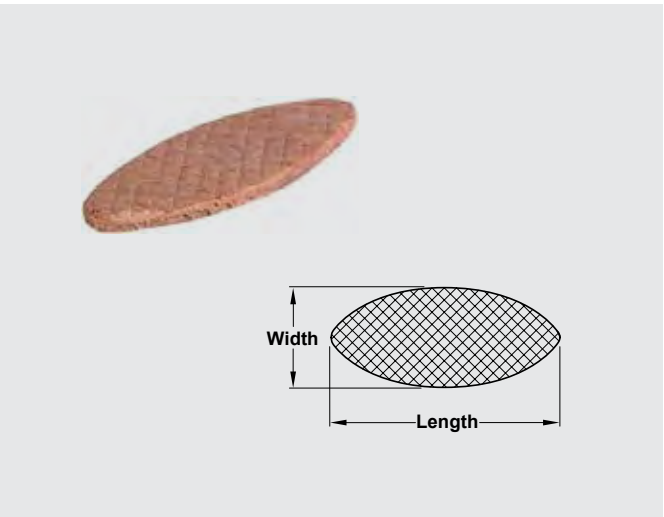

- > Material: beech
- > Thickness: 4 mm

Size	For groove depth (mm)	Dimensions (mm) L x W	Cat. No.
0	8	47 x 15	267.90.000
10	10	53 x 19	267.90.010
20	12	56 x 23	267.90.020

**Packing:** 1000 pieces

CUNI FURNITURE WEDGES

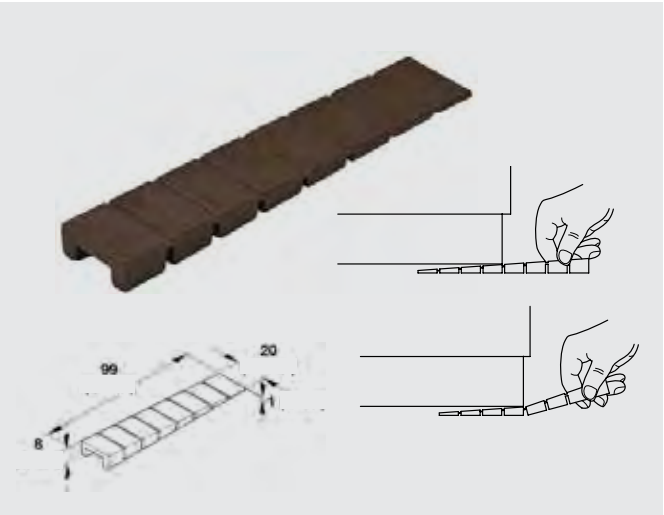

- > The Cuni wedge strips ensure that furniture is perfectly level, allowing furniture doors to function correctly. Furniture can be levelled effortlessly and precisely to the millimeter with plastic Cuni wedge strips
- > Mounting: Place the strip under furniture to level. Once level, simply snap off the Cuni sections. Sections can be broken off from 1 mm to 8 mm
- > Material: plastic, brown

Cat. No.
006.90.900

**Packing:** 500 pieces

## STAPLES

- > For areas where corrosion resistance is not necessary
- > Two legs are better than one. In many applications, staples have greater holding power over a nail. Chisel points: less splitting in hardwood, economical. Most staples are produced from electroplated wire and so are not guaranteed against corrosion. When staples are formed, the points are exposed as bright wire
- > Material: Steel wire, galvanised
- > Typical thickness: 15-25 gr / m2
- > Points: Chisel point is a standard finish
- > Gauge is sometimes used to describe a staple wire diameter

Gauge	Wire Ø (mm)
23	0.64
22	0.70
21	0.84
18	1.20
16	1.55
15	1.80
14	2.05

### Chisel Point

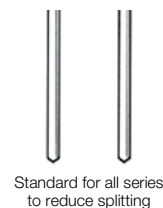

## SENCO M-SERIES STAPLES

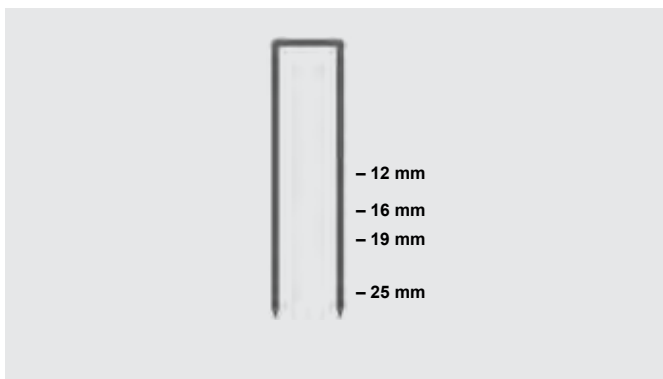

- > For kitchen units, cabinet making, furniture frames, chair frames
- > Material: steel wire galvanised
- > Crown width: 9.5 mm
- > Wire size: 1.00 x 1.25 mm, 18 gauge
- > Wire diameter: 1.20 mm

Length (mm)	Packing (pieces)	Cat. No.
12	10000	006.51.002
16	5000	006.51.003
19	5000	006.51.004
25	5000	006.51.006

## AIRCO 80 SERIES STAPLES

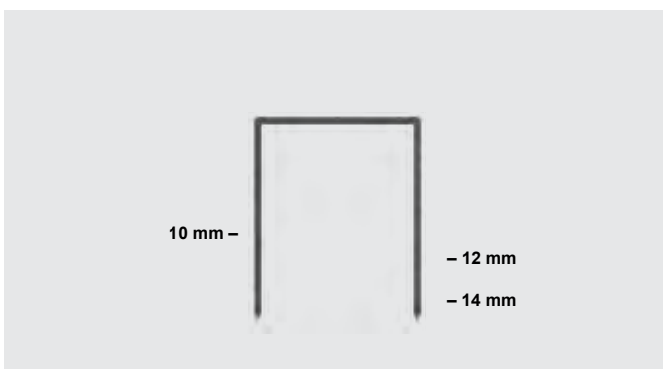

- > For upholstery, beading, cupboard backs, mattress bases, labelling, decorative moulds, framing
- > Material: steel, galvanised
- > Wire size: 0.65 x 0.95 mm, 21 gauge
- > Wire diameter: 0.84 mm
- > Crown width: Airco: 12.9mm

Length (mm)	Packing (pieces)	Cat. No.
10	10000	006.50.582
12	10000	006.50.583
14	10000	006.50.584

## 6000 SERIES / L-SERIES STAPLES

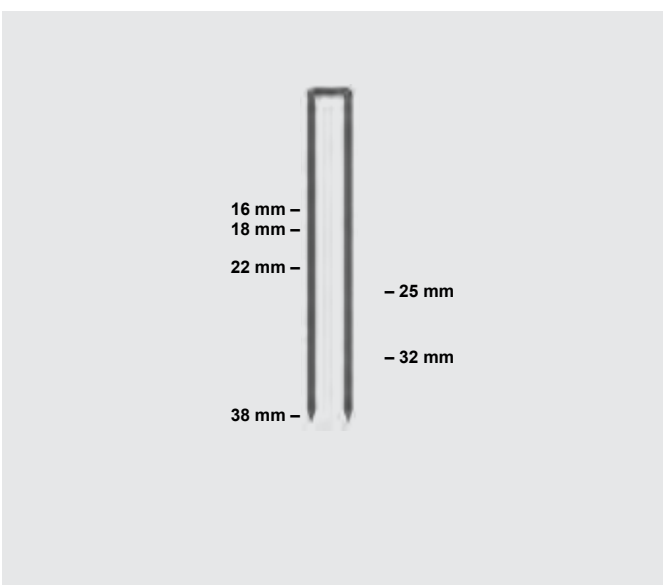

- > For upholstery, beading, cupboard backs, mattress bases, labelling, decorative moulds, framing
- > Material: steel, galvanised
- > Wire size: 1.0 x 1.25 mm, 18 gauge
- > Wire diameter: 1.20 mm
- > Crown width: Airco: 5.5 mm, Senco 6.4 mm

Length (mm)	Packing (pieces)	Cat. No.
<b>Airco 6000 series</b>		
18	5000	006.50.672
25	5000	006.50.676
32	5000	006.50.678
38	5000	006.50.679
<b>Senco L series</b>		
16	5000	006.51.021
22	5000	006.51.023
32	5000	006.51.026
38	5000	006.51.027

## BRADS

- > For areas where corrosion resistance is not necessary
- > Economical, reduced splitting. Head and points are cut from pre-galvanised wire and are not guaranteed or warranted against corrosion as bright wire is exposed
- > Material: steel wire, electro-galvanised/bright coated
- > Typical thickness of zinc: 15 - 25 gr / m<sup>2</sup>
- > Points: Chisel point is a standard finish
- > Load capacity: 100 brads (1 strip)
- > Gauge is sometimes used to describe a brad wire diameter

Series	Gauge	Wire Ø (mm)
CI	18	1.20
C	16	1.55
DA	15	1.80

### Chisel Point

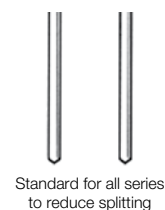

## DA BRADS

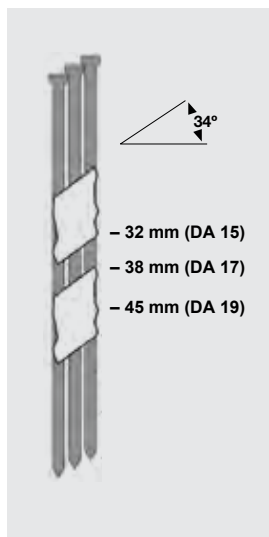

- > Application: Architraves, general fix out
- > Material: steel wire, bright coated
- > Head diameter: Ø3.1 mm
- > Wire diameter: 1.80 mm, 15 gauge
- > Tool types: Airco TDD1564 or Senco FN65DA, FIP35MG
- > Tool type listed above accept both Airco and Senco brads itemised

## AIRCO C1 SERIES BRADS

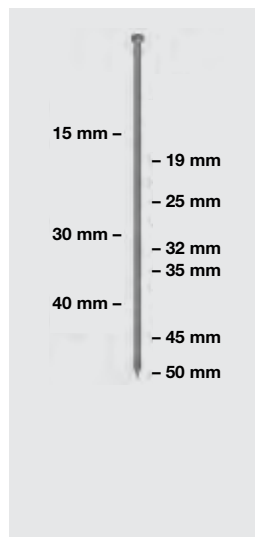

- > Application: Architraves, shop fitting, cabinet making, interior trim fit out, window & door manufacturing.
- > Material: steel wire, bright coated
- > Head diameter: 2.0 x 1.0 mm
- > Wire diameter: 1.20 mm, 18 gauge
- > Tool types: Airco TTF1832, TTF1857 or Senco FIP18

Length (mm)	Packing (pieces)	Cat. No.
<b>Airco DA series</b>		
32	3000	006.51.172
38	3000	006.51.173
45	3000	006.51.174
<b>Senco DA series</b>		
38	3000	006.51.062
45	3000	006.51.063

Length (mm)	Packing (pieces)	Cat. No.
15	5000	006.51.141
19	5000	006.51.143
25	5000	006.51.144
30	5000	006.51.145
32	5000	006.51.146
35	5000	006.51.147
40	5000	006.51.148
45	5000	006.51.149
50	5000	006.51.150

## AIRCO C SERIES BRADS

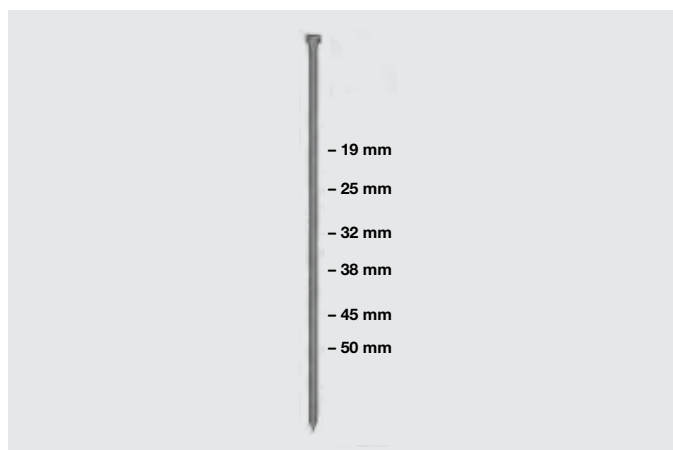

- > For architraves, window manufacturing, shop fittings, door manufacturing, cabinet making, kitchen cupboards, interior panelling, interior trim fit out
- > Material: steel wire, galvanised
- > Head diameter: Ø2.8 x 1.4mm
- > Wire size: 1.4 x 1.6 mm, 16 gauge
- > Wire diameter: Ø1.55 mm
- > Tool types: Airco TTC1650 or Senco FN65RHA, FIP16XP

Length (mm)	Packing (pieces)	Cat. No.
19	5000	006.51.160
25	5000	006.51.161
32	5000	006.51.163
38	5000	006.51.165
45	5000	006.51.166
50	5000	006.51.167

SENCO 80 SERIES STAPLER



- > Rear magazine bumper, comfort grip. Rear exhaust, full 25.4 mm lip length, safety trigger
- > Magazine capacity: 157 staples
- > Fastener range: 6 - 16 mm
- > Operating pressure: 70-120 PSI
- > Trigger: single shot
- > Body material: magnesium
- > Dimensions (H x L): 151 x 241 mm
- > Weight: 950 g

Cat. No.
006.50.681

Packing: 1 piece

SENCO C1 FIXING NAILER



- > Soft grip handle, adjustable belt hook. Rear exhaust, side load magazine. Low load indicator
- > Magazine capacity: 110 nails
- > Fastener range: 16 - 50 mm
- > Operating pressure: 70-120 PSI
- > Trigger: dual action
- > Body material: magnesium
- > Dimensions (H x L): 151 x 241 mm
- > Weight: 950 g

Cat. No.
006.50.682

Packing: 1 piece

SENCO C BRAD NAILER



- > Soft grip handle, adjustable belt hook. Compact body and magazine, 360° adjustable exhaust, dry-fire lockout
- > Magazine capacity: 110 nails
- > Fastener range: 16 - 50 mm
- > Operating pressure: 70-120 PSI
- > Trigger: dual action
- > Body material: magnesium
- > Dimensions (H x L): 290 x 303 mm
- > Weight: 1.8 kg

Cat. No.
006.50.683

Packing: 1 piece

FISCHER HM METAL CAVITY FIXING



- > For metric screws, plasterboards and gypsum fibre boards, chipboard, hollow-block ceilings, plywood with metric screw
- > Material: Steel galvanized

**Installation:**

- > Expanding arms and radial pressure increase the load bearing capacity and security
- > Claws prevent the wall plug from rotating when being installed
- > The flush-fitted, permanently expanded wall plug allows removing and refitting of the surface mounted part for several times
- > Each dimension covers an extensive range of panel thicknesses
- > The wall plug can be mounted either with installation with a cordless screwdriver or screwdriver

Type	Drill bit Ø D (mm)	Drill hole depth T (mm)	Panel thickness Dp (mm)	Wall plug length L (mm)	Screw Dimensions
HM5 x 52S	10	>62	7 – 21	>52	M5 x 60
HM5 x 65S	10	>75	20 – 34	>65	M5 x 73

Model	Cat. No.
HM 5 x 52 S	051.80.004
HM 5 x 65 S	051.80.005

**Packing:** 50 pieces

FISCHER HM METAL CAVITY FIXING MOUNTING SET



- > Suitable for plasterboard, gypsum fibre boards, chipboard, dry lining walls, hollow ceilings, cladding, panels, etc. with a thickness of 7-21 mm with HM 5 x 52 or with HM 5 x 65 mm, for fixing objects with a thickness of max. 24 mm
- > With installation pliers for quick and comfortable fixing of metal cavity fixings in board materials, installation with a cordless screwdriver or screwdriver
- > Supplied with: 20 HM metal cavity fixings 5 x 52 mm + screws, 10 HM metal cavity fixings 5 x 65 mm + screws, 1 HM Z 3 installation pliers

Cat. No.
051.81.020

**Packing:** 1 piece

FISCHER GK AND GK GREEN PLASTERBOARD DOWEL

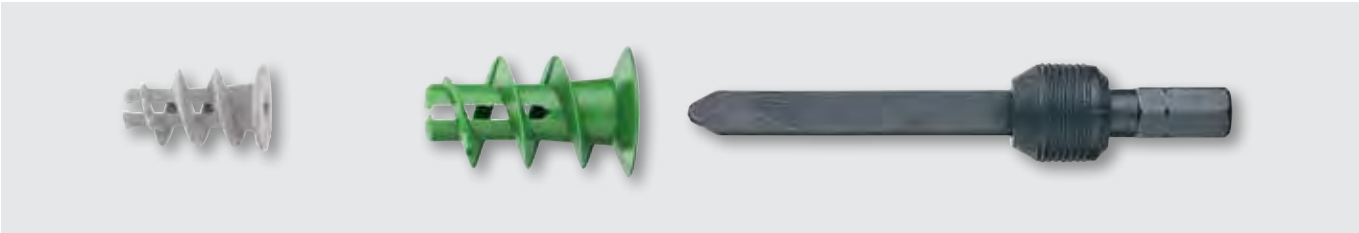

- > For single and double plasterboards, rear-insulated plasterboard, little space requirement behind the board, adapted to wood, sheet metal and chipboard screws Ø 4.0–5.0 mm, not suitable for tiled plasterboards, gypsum fibre boards
- > With continuous groove for a perfect fit and force transmission of the setting tool, with sharp, self-tapping thread for a secure, positive-fitting and load-bearing connection with the construction material, with cross slot drive for processing, even without a screwdriving tool, can also be used with unknown panel thickness and cavity depth due to short wall plug length
- > Material: Polyamide

Installation:

- > The wall plug grips into plasterboard using the supplied setting tool providing a positive-fit
- > Screwdriving tool for drill chuck supplied (use bit holder)
- > Installation with cordless/electric screwdriver without pilot drilling (pilot drilling required from panel thickness >15 mm)

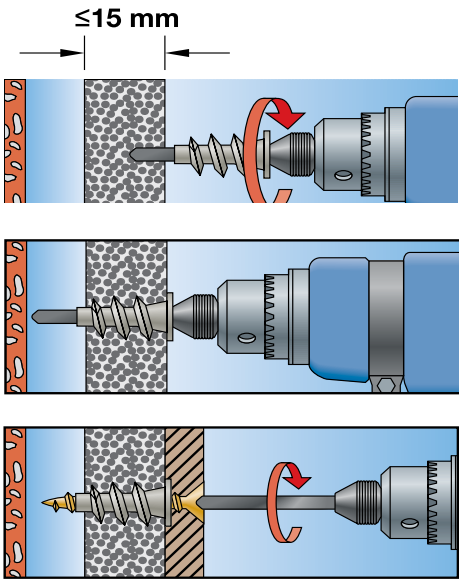
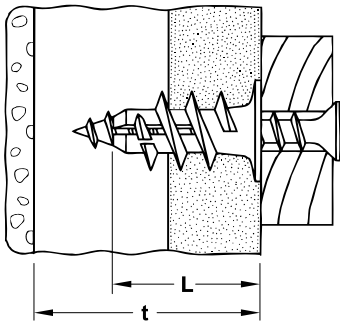

Type	Wall plug length L (mm)	For screw Ø (mm)	Thickness to first bearing layer (mm)
GK	22	4-5	>25

Model	Material	Supplied with	Packing (pieces)	Cat. No.
GK	Polyamide	1 pack of wall plugs	100	051.63.000
GK GREEN	Polyamide, made from at least 50 % sustainable raw materials	1 pack of wall plugs 1 setting tool	90	051.63.002



E-Z ANCHORS® PLUGS

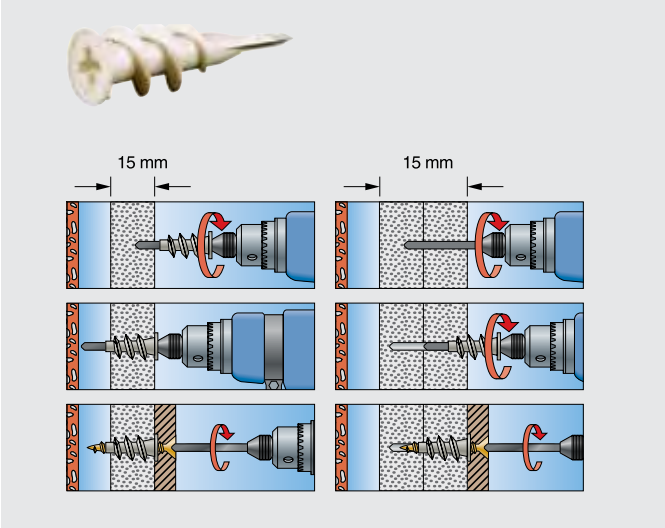

- > Suitable for single and double plasterboard, rear insulated plasterboard
- > Fast, self-drilling, up to 15 mm thick, one step installation. Easy installation with a 2 phillips screwdriver. The E-Z anchor can be taken out of the wall as easily as it has been put in. The deep thread holds fast in 10, 12 or 16 mm plasterboard. Holds up to 30 kg shear strength (depending on material strength). The unique point cuts cleanly into wall and the head sits flush.

Cat. No.
051.18.036

Packing: 100 pieces

E-Z ANCHORS® PLUGS

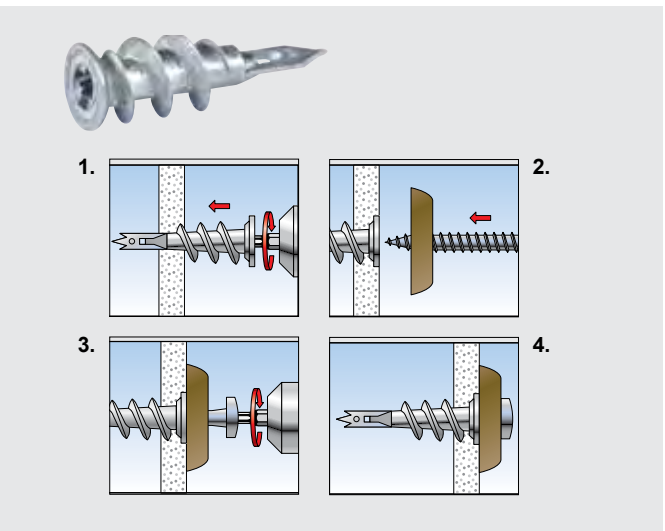

- > Suitable for single and double plasterboard, rear insulated plasterboard
- > Fast, self-drilling, up to 15 mm thick, one step installation. Easy installation with a 2 phillips screwdriver. The E-Z anchor can be taken out of the wall as easily as it has been put in. The deep thread holds fast in 10, 12 or 16 mm plasterboard. Holds up to 22 kg shear strength (depending on material strength). The unique point cuts cleanly into wall and the head sits flush. Corrosion resistant: E-Z anchor will not rust, stain or streak. Fitted with a battery/electric driver-drill without pre-drilling (plasterboard thicker than 15 mm should be pre-drilled.).

Cat. No.
051.18.027

Packing: 100 pieces

E-Z TOGGLES®

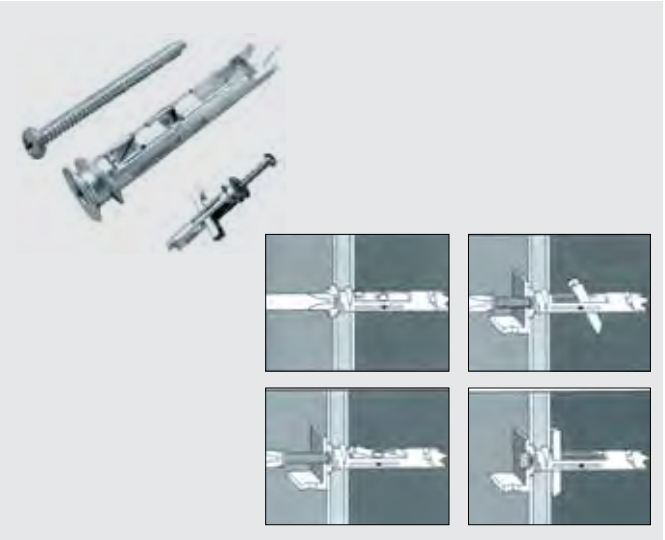

- > Now you can mount heavy objects to plasterboard without drilling, cutting, hammering or hunting for studs. With just a 2 phillips screwdriver, you can install the E-Z Toggle® bolt and you are ready to go. Holds up to 50 kg shear strength (depending on material strength)
- > For material thickness 0-12 mm
- > Material: steel, galvanised
- > Size: 4 x 54 mm

Cat. No.
051.17.911

Packing: 1 piece

## FISCHER S WALL PLUG

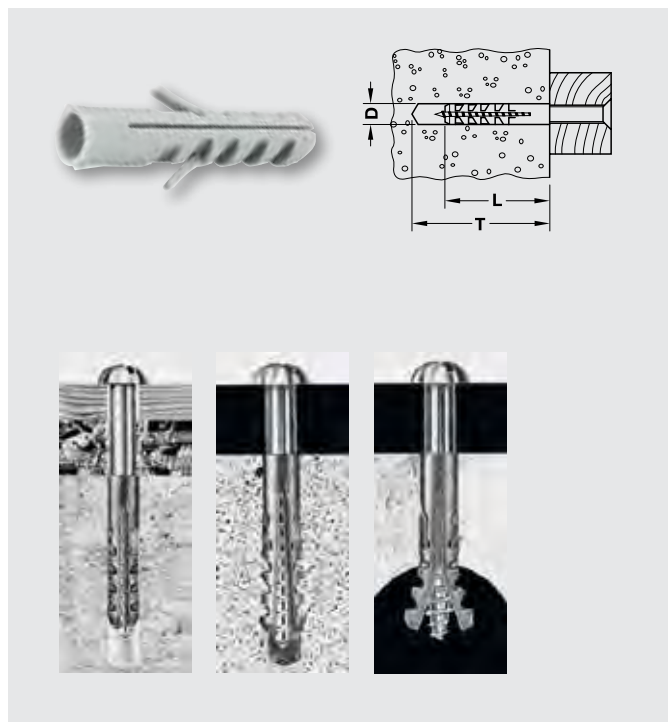

### Note:

Max. load bearing capacity is achieved by using the maximum screw Ø and screws, that protrude the wall plug tip by the screw diameter, vacuum or blow-out drill hole

- > Suitable for concrete, masonry wall material, perforated bricks, aircrete (gas concrete), lightweight material resistant to weathering, ageing, corrosion and rotting, with vibration-absorbing and sound proofing effect, largely resistant against most chemical influences, good electrical insulating properties
- > Material: Polyamide
- > Temperature resistance: -40 to +80°C

### Installation:

- > For pre-mounting with wood and chipboard screws
- > High tensile and compression strength
- > Frictional connection in solid building material
- > Positive-fit connection in soft and rough building material
- > Locking lugs prevent turning in the drilled hole
- > The expansion stress-free plug neck prevents surface damage to tiles and plaster

Type	Drill bit Ø D (mm)	Drill hole depth T (mm)	Wall plug length L (mm)	For screw Ø (mm)
S6	6	>40	30	4-5
S8	8	>55	40	4.5-6
S10	10	>70	50	6-8

Model	Packing (pieces)	Cat. No.
S6	200	051.40.018
S8	200	051.40.027
S10	100	051.40.036

## FISCHER DUOPOWER WALL PLUG

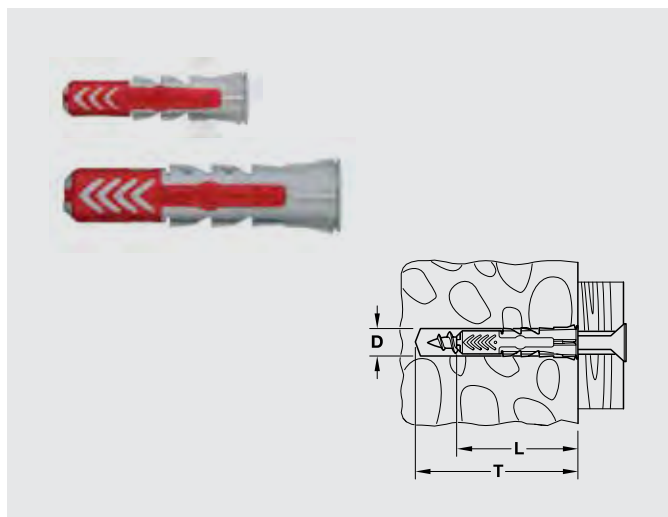

- > For concrete, solid red brick, sand-lime brick, aircrete, vertically perforated brick, perforated sand-lime brick, plaster-based construction board, plasterboard and gypsum fibre board, hollow brick made from light concrete, hollow ceilings made from red bricks, prestressed concrete or similar, natural stone, chipboard, solid gypsum board, solid brick made from light concrete.
- > Deep drilling not required due to the short plug length, no over-tightening of the screw and the combination of 2 components ensures good load bearing capacities
- > Material: polyamide

Type	Drill bit Ø D (mm)	Drill hole depth T (mm)	Wall plug length L (mm)	For screw Ø (mm)
6 x 50	6	>60	50	4-5
8 x 65	8	>75	65	4.5-6

Model	Packing (pieces)	Cat. No.
Duopower 6 x 50 mm	100	051.48.004
Duopower 8 x 65 mm	50	051.48.005

### 203 PREMIUM SPRAY CONTACT ADHESIVE



- > A high heat resistant, high solids spray adhesive, used for bonding decorative laminates for cabinet making and shop fitting applications

	Colour	Cat. No.
20 ltr	Red	003.56.961
	Clear	003.56.960

**Packing:** 1 piece

### 101 CONTACT CLEANER



- > Formulated for the clean up of metal tools and spray guns used in the application of contact adhesives (not suitable for ABS edging or polystyrene surfaces)

	Cat. No.
20 ltr	003.50.995

**Packing:** 1 piece

### 205 BRUSH CONTACT ADHESIVE



- > Adhesive formulated to be applied by brush or roller used for bonding decorative laminates for cabinet making and shopfitting applications

	Cat. No.
4 ltr	003.56.970

**Packing:** 1 piece

### HÄFELE CONTACT ADHESIVE



- > Suited for most small laminating jobs in the cabinet making industry such as edge strips, kick panels etc.
- > Web spray pattern provides ease of application and prevents 'soak in', High temperature resistance (104°C), Fast track
- > Premium grade laminating adhesive, ensures high strength bonds
- > Colour: Natural
- > Tack time: 3-5 min dependant on conditions
- > Clean up: ACR citrus cleaner
- > Application temp: 12 to 14°C
- > Temp rating: 104°C
- > Shelf life: 12 Month
- > Product density: 960 gms/l

	Cat. No.
482 ml	003.50.210

**Packing:** 1 piece

### AV 56 LAMINATED BOARD ADHESIVE



- > For bonding of laminates, imitation marble, melamine and vinyls to particle board, timber and fibre board
- > AV56 is a unique adhesive for binding non porous to porous and semi-porous substrates, very high bond strength, non flammable, clean up with water, single pack

	Cat. No.
5 ltr	003.56.090
20 ltr	003.56.091

**Packing:** 1 piece

### AV 180 MDF BOARD AND JOINERY ADHESIVE



- > Design to complement the performance of MDF board with excellent machining and sanding characteristics
- > Very high bond strength, non flammable, clean up with water, single pack, fast setting, excellent sandability

	Cat. No.
5 ltr	003.17.040
20 ltr	003.17.041

**Packing:** 1 piece

## TAC MELAMINE ADHESIVE



- > Typically used to bond end grain to melamine face in the manufacture of cabinets, cupboards and drawers
- > Dries clear and has very high bond strength and specific adhesion to melamine face and other difficult to bond surfaces
- > Coverage rate, open time and press time are dependant on types of materials to be bonded as well as workshop conditions such as temperature and humidity

	Cat. No.
5 ltr	003.09.415

**Packing:** 1 piece

## HÄFELE 501 POLYURETHANE



- > HÄFELE 501 bonds timber, MDF, melamine board and most other materials. It can be used for internal and external applications, has a D/4 rating and a high bond strength

	Cat. No.
500 ml	003.57.062
5 kg	003.57.063

**Packing:** 1 piece

## DORUS® WL 4068



- > General purpose, water based, polyvinyl acetate adhesive suitable for bonding most hard and soft woods in joinery applications
- > Complies with AS-2754-2 types 4, 5 standards

	Cat. No.
21 kg	003.09.401

**Packing:** 1 piece

## HÄFELE 301 PREMIUM MDF AND TIMBER PVA



- > Designed for MDF and timber, HÄFELE 301 is a yellow coloured adhesive to differentiate from standard white PVA adhesive

	Cat. No.
5 ltr	003.09.420
20 ltr	003.09.421

**Packing:** 1 piece

## EMPTY GLUE BOTTLE WITH NOZZLE



	Cat. No.
500 ml	003.09.412

**Packing:** 1 piece

## DORUS® EXPRESS



- > DORUS Express is a precatylased good shelf life, thermosetting, cross linkable polyvinyl acetate dispersion
- > It is suitable for edgegluing, veneering, joinery, etc and conforms to BS EN 204

	Cat. No.
10 kg	003.09.400

**Packing:** 1 piece

**DORUS® ADHESIVES FOR EDGEBANDING****Hotmelt**

Häfele is the exclusive Australian and New Zealand distributor to the woodworking industry for DORUS® edgebanding hot melts.

DORUS® offers cartridge and granular type edgebanding hotmelts with a wide variety of suitable applications from difficult solid wood lippings to thick PVC/ABS-edges, 3mm up.

The "original" cartridge HKP 21 and HKP 25 are available in natural and white. DORUS® granulates KS 205 and KS217 set industry standards for a tough, durable bond under a variety of demanding conditions; while KS224/2 and KS208/2 are industry leaders in economically priced applications.

**Spherical hotmelt glue granules**

The hotmelt granulate is now supplied in spherical form instead of cylindrical. Advantages compared to cylindrical:

- > Higher bulk density
- > Less volume
- > Improved thermal conductivity during the melting process
- > Improved flow ability
- > Excellent flow into melting unit
- > Uniform granulate size

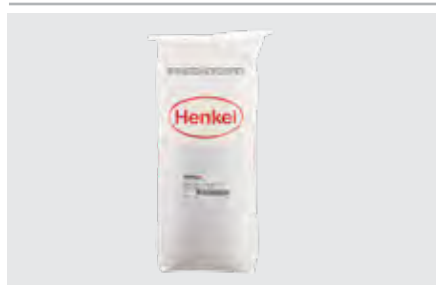
**TECHNOMELT DORUS® KS205**

- > High quality for all conventional types of edges, including solid wood lippings, PVC/ABS and soft forming

Colour	Cat. No.
Natural	003.09.606
White	003.09.615

**Packing:** 25 kg bag

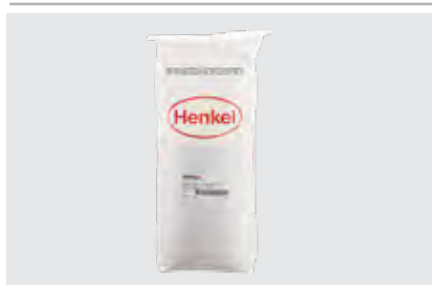
**TECHNOMELT DORUS® KS208/2**

- > Economical multi-purpose type recommended for straight edges of veneer, melamine and PVC/ABS, high final bond strength, high heat resistance

Colour	Cat. No.
Natural	003.09.722

**Packing:** 25 kg bag

**TECHNOMELT DORUS® KS217**

- > High quality for all conventional types of edges, including solid wood lippings and PVC/ABS, designed for quickmelt systems and conventional application, no soft foaming
- > Granular type adhesive

Colour	Cat. No.
Natural	003.09.624

**Packing:** 25 kg bag

**TECHNOMELT DORUS® KS351**

- > Clean processing without stringing, giving hardly visible glue line. For all conventional types of edgings, including veneer, melamine, PVC/ABS, soft foaming. Designed for machine speed: 12 m per minute up. High heat resistance
- > Granular type adhesive

Colour	Cat. No.
Clear	003.09.540

**Packing:** 25 kg bag

**TECHNOMELT KS922**

- > Clean processing without stringing, giving hardly visible glue line. A high heat resistance leads to high product performance and a low coating weight ensures an economical balance
- > Granular type adhesive

Colour	Cat. No.
Clear	003.09.544

**Packing:** 25 kg bag

**TECHNOMELT DORUS® HKP25**

- > The original high quality all purpose type cartridge to suit cartridge type edgebanding machine, suitable for all conventional edges including solid timber lippings, PVC/ABS edges.
- > Cartridge type adhesive for Holzher edgebanding machines

Colour	Cat. No.
Natural	003.09.661
White	003.09.841

**Packing:** 15 kg carton (45 cartridges)

### ABS EDGE BAND CLEANER



- > To clean hotmelt and solvent-based adhesive from ABS edgeband without attacking the edge
- > Low odour, fast drying and leaves minimal residue
- > To use, simply soak a clean rag and wipe the adhesive off edgeband

	Cat. No.
20 ltr	003.50.992

**Packing:** 1 piece

### ABS EDGE BAND CLEANER PLUS



- > Formulated to clean off hotmelt and contact adhesives as well as pencil, pen and marking pen from ABS edging without attacking the edge

	Cat. No.
20 ltr	003.50.998

**Packing:** 1 piece

### DRUM TAP FOR ABS EDGE BAND CLEANER



- > Enables the transfer of ABS edgeband and contact cleaner to smaller bottles

	Cat. No.
	003.50.999

**Packing:** 1 piece

### HÄFELE RAPID ADHESIVE SUPERGLUE



- > Dual component assembly adhesive, cyanoacrylate based. Rapid activation with hardener (see right-hand side). Can also be used without hardener

	Cat. No.
50 ml	003.04.000

**Packing:** 1 piece

### HÄFELE HARDENER FOR RAPID ADHESIVE



- > For fast activation of Häfele rapid adhesive. To be applied to the receiving surface of the joint

	Cat. No.
200 ml	003.04.010

**Packing:** 1 piece



## INDUSTRIAL GRADE SILICONE



- > A general purpose, U.V resistant, one component, neutral cure oxime silicone sealant
- > Excellent multi purpose sealant, permanently flexible, suitable for interior and exterior applications. Unaffected by rain, snow, extreme temperature change and constant ultra violet exposure. Waterproof superior adhesion properties, low odour

Colour	Cat. No.
Clear	003.50.008
White	003.50.009

**Packing:** 1 piece (300 ml cartridge), 20 pieces per box

## 6S SANITARY SILICONE



- > One component, non flowing, neutral cure, mid modulus silicone sealant
- > Contains effective fungicide, minimises the growth of mould and mildew, Excellent adhesion to powder-coated metal. Will not slump in typical construction joints. Consistent, even cure, easy to use in difficult locations, easy mixing and long life reliability

Colour	Cat. No.
Clear	003.50.023
White	003.50.024

**Packing:** 1 piece (300 ml cartridge), 20 pieces per box

## V60 STRUCTURAL SILICONE



- > Bostik V60 is a high performance architectural grade glazing silicone. One component, non-flowing, neutral cure, high modulus sealant. It cures by absorption of atmospheric moisture to form a flexible and durable elastomeric sealant.
- > Superior adhesion to painted and anodised aluminum & glass. Thixotropic nature of this product ensures that it will not slump in typical construction joints. Excellent UV stability, long life reliability. Bostik V60 has excellent natural ageing stability. It will maintain its elastomeric joint sealant properties permanently, even under harsh conditions and temperature extremes.

Colour	Cat. No.
Black	003.50.450
Grey	003.50.451
Matt Black	003.50.452
White	003.50.453
Clear	003.50.454

**Packing:** 1 piece (300 ml cartridge), 15 pieces per box

## KITCHEN AND BATHROOM SILICONE



- > Bostik Kitchen & Bathroom Acetic Cure is a premium, acetoxo-curing, wet area silicone sealant. It is specially formulated to resist mildew when exposed to prolonged hot and humid environments. Acetic (acetoxo) curing kitchen and bathroom sealant, resists mould & mildew in hot and humid environments. Flexible silicone rubber, joint movement capabilities  $\pm 25\%$ , maintains a waterproof flexible joint. Acetoxo silicones stay clearer than oxime silicones over time, excellent UV resistance, watermark approved. Rapid curing, ideal for darker bathrooms/laundries and non-porous surfaces. For use on glass, ceramics, fibre glass, porcelain, laminate, copper\* and brass\*. Contains active fungicide

Colour	Cat. No.
Clear	003.50.440
White	003.50.441

**Packing:** 1 piece (300 ml cartridge), 20 pieces per box

### SIMSON ISR 70-03



- > ISR 70-03 is a good compromise between an adhesive and a sealant. ISR 70-03 is suitable for making elastic constructive joints, which also require a high strength
- > Very good UV-resistance and ageing properties, good adhesion on several substrates without the use of a primer. Neutral, odourless and fast curing. Pick resistant, paintable after skin forming (wet on wet); this will not influence the curing speed. Not Suitable for construction movement joints

Colour	Cat. No.
White	003.50.430
Black	003.50.431
Grey	003.50.432

**Packing:** 1 piece (290 ml cartridge), 12 pieces per box

### SIMSON ISR 70-05AP



- > ISR 70-05 AP is a Silyl Modified Polymer (SMP) based adhesive with a high tensile strength and is suitable for making elastic constructive joints. Bostik Simson ISR 70-05 AP can also be used as a sealant and has been tested and certified to the International Maritime Organisation Fire Test Procedures for Surface Flammability, resolution A.687 and is approved for bonding deck materials onto steel or aluminium
- > Very good UV-resistance and ageing properties. Good adhesion on several substrates without the use of a primer. Neutral, odourless and fast curing, paintable after skin forming (wet on wet); this will not influence the curing speed. Not Suitable for construction movement joints

Colour	Cat. No.
White	003.50.433
Grey	003.50.434
Black	003.50.435

**Packing:** 1 piece (290 ml cartridge), 12 pieces per box

### NO MORE NAILS

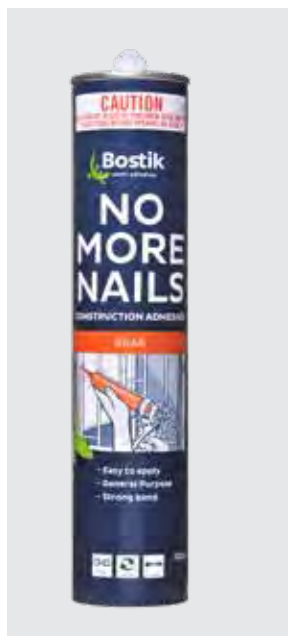

- > A versatile general purpose construction adhesive suitable for bonding a wide variety of building materials. Its superb bond strength is ideal for demanding situations
- > Polystyrene safe, bonds to most surfaces, high modulus, easy gunning, fast curing. Suited for interior and exterior applications. Bonds immediately on contact, adds rigidity and stiffness to help eliminate movement

Cat. No.
003.50.181

**Packing:** 1 piece (320 gm cartridge), 15 pieces per box

### GAP FILLER



- > A general purpose, water based, acrylic gap filler, suitable for use on interior and exterior areas prior to painting. It offers excellent adhesion properties suitable for sealing gaps and low movement joints.
- > Excellent sealing and adhesion. Slump resistant, skins within 15 minutes, can be painted over after 2 hours, water clean up, environmentally friendly. Low VOC

Colour	Cat. No.
White	003.50.075

**Packing:** 1 piece (450 gm cartridge), 20 pieces per box

FIREBAN® HYBRID



- > High performance and durable single component fire retardant sealant based on MSP (Modified Silyl-Polymer) technology. Fireban® Hybrid absorbs movements up to 25% and cures with the aid of atmospheric humidity to form a durable elastic rubber
- > Up to 4 hours of fire resistance, tested in accordance with AS 1530.4-2014, also suitable for wall/ceiling and wall/floor joints, applicable for joints up to 30mm wide, prevents unwanted airflows, accommodates joint movement up to 25%, weather and water resistant, durable and odourless

Colour	Cat. No.
White	003.50.003

**Packing:** 1 piece (300 ml cartridge)

ANCHOR WELD TM



- > A high strength, general purpose solvent based mastic adhesive
- > High bond strength, excellent adhesion properties, good slump resistance, good temperature resistance. Excellent moisture resistance

	Cat. No.
	003.50.094

**Packing:** 1 piece (270 gm cartridge), 20 pieces per box

AV 515



- > For bonding hardwood species such as spotted gum, black butt and brush box
- > Very high bond strength, non flammable, solvent free, fast set, water, weathering and aging resistant. Certified to EN204 D4

	Cat. No.
	003.50.093

**Packing:** 1 piece (300 ml cartridge), 12 pieces per box

### SET OF ANGLED FORMERS



- > For a constant and technically correct removal of filler at a 45° angle. For all commercial sealants.
- > Highly flexible, non-abrasive, acid resistant, edges and shape stable
- > Contains three formers with lengths of 3, 5, 6, 8 and 10 mm

	Cat. No.
	003.52.230

**Packing:** 1 pack

### SET OF ANGLED FORMERS



- > For a constant and technically correct removal of filler. For all commercial sealants.
- > Highly flexible, non-abrasive, acid resistant, edges and shape stable
- > Contains three formers with lengths of 4, 6, 8, 10, 12 and 14 mm

	Cat. No.
	003.52.220

**Packing:** 1 pack

### APPLICATION EXAMPLE



### HANDY WIPES



- > Waterless hand towels that have a convenient scrub side for removing tough grime and one for gentle wiping away
- > Especially formulated to quickly and effectively remove sealant, tar, dirt, grease, oil, adhesive, paint and ink from tools and equipment

	Cat. No.
	007.59.202

**Packing:** 1 piece (6 pieces per box)

### STAINLESS STEEL CLEANING SPRAY



- > To protect stainless steel sinks and appliances from scratches, finger prints and imperfections. Removes grease and other stains easily

	Cat. No.
400 ml	003.52.810

**Packing:** 1 piece

### VUPLEX CLEANER/ POLISH



- > Cleans and polishes surfaces ideal for use on acrylic benchtops and splashbacks

	Cat. No.
200 ml	007.32.131

**Packing:** 1 piece

FURNITURE REPAIR CRAYONS

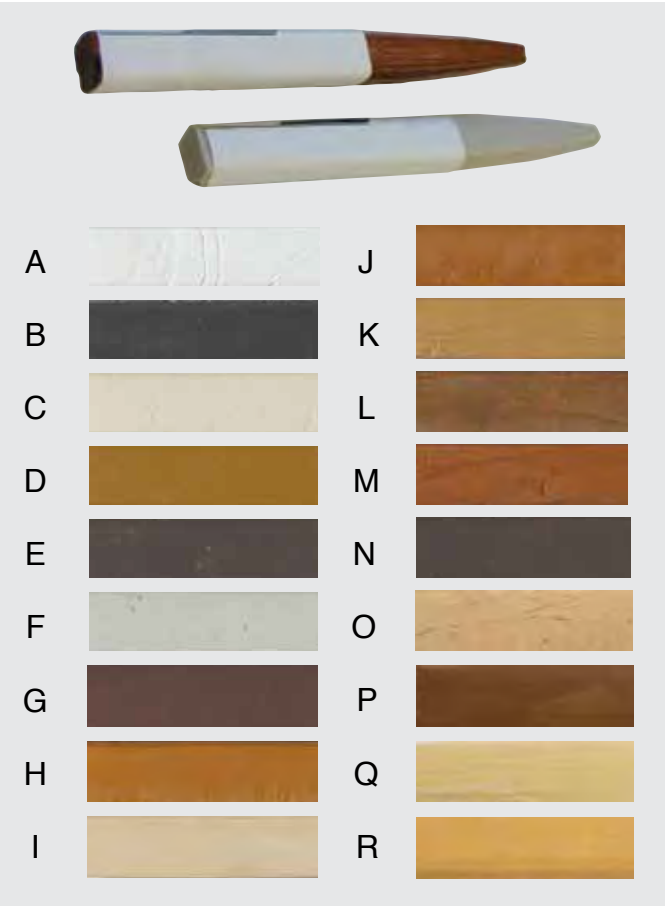

- > Furniture repair crayons are used to fill in and recolour small scratches or cut damage in furniture: Rub crayon over scratch, rub off excess wax with soft cloth
- > Colours shown are a representation of timber species only

Colour		Cat. No.
A	White	007.33.030
B	Black	007.33.031
C	Antique white	007.33.047
D	Baltic pine	007.33.043
E	Dark walnut	007.33.038
F	Folkstone	007.33.040
G	Jarrah	007.33.042
H	Light teak	007.33.035
I	Marl beige	007.33.032
J	Red cherry	007.33.048
K	Select beech	007.33.049
L	Teak	007.33.034
M	Wild birch	007.33.050
N	Walnut	007.33.037
O	Limed oak	007.33.045
P	Dark teak	007.33.036
Q	Manhattan beige	007.33.033
R	Victorian ash	007.33.041

Packing: 1 piece

SOFT-WAX ASSORTMENT



- > For repairing or restoring wooden surfaces

	Cat. No.
White to Black	007.30.060
Furniture shades	007.30.070
Light wood shades	007.30.080

Packing: 1 set

TOUCH UP PENS



- > For repairing or restoring wooden surfaces
- > Supplied with: 1 touch up pen each of: Maple / Birch / Ash, Natural beech, Rustic oak, Light cherrywood, Natural cherrywood / Alder, Red mahogany, Light walnut, Dark walnut, Teak

	Cat. No.
	007.33.012

Packing: 1 set

LUBRICATING WAX



- > For repairing jamming, squeaky or warped running surfaces of doors, drawers and tambour doors
- > Dimension: 80 x 20 x 15 mm

	Cat. No.
	007.34.556

Packing: 1 piece

### TESA 4688 - WATER PROOF CLOTH TAPE (GAFFA TAPE)

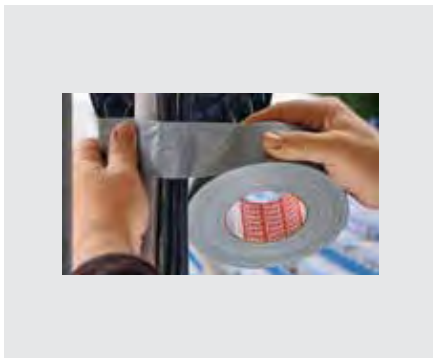

- > Hand tearable water proof cloth tape, adhering plastic sheeting to various substrates, general repair of plastics and fabrics. Very aggressive adhesive
- > Thickness: 0.26 mm

Size (mm x m)	Colour	Cat. No.
48 x 25	Black	003.58.015
	Silver	003.58.016

**Packing:** 1 roll

### TESA 4309 - HIGH TEMP/ PERFORMANCE MASKING TAPE



- > For paint spraying with subsequent oven drying up to a temperature of 120°C. Finely creped, extremely stretchable and flexible paper masking tape
- > Thickness: 0.17 mm

Size (mm x m)	Cat. No.
25 x 50	007.81.231
38 x 50	007.81.232

**Packing:** 1 roll

### TESA 50101 - GENERAL PURPOSE PAPER MASKING TAPE



- > Finely creped paper masking tape with a natural rubber adhesive. This product is suitable for general purpose applications
- > Thickness: 0.13 mm

Size (mm x m)	Cat. No.
18 x 50	003.08.010
24 x 50	003.08.011
36 x 50	003.08.012
48 x 50	003.08.013

**Packing:** 1 roll

### TESA 4952 - DOUBLE SIDED PE FOAM MOUNTING TAPE



- > Double sided self adhesive white foam tape with high resistance to humidity. Fixing of mirrors in humid rooms. Self-adhesive mounting of cable clips and cable covers. Fixing of splashbacks/panels
- > Thickness: 1.2 mm

Size (mm x m)	Cat. No.
18 x 50	003.58.103
24 x 50	003.58.104
48 x 50	003.58.105

**Packing:** 1 roll

### TESA 7078 ACXPLUS - DOUBLE SIDED HIGH BOND TAPE



- > Double sided (high bond) black acrylic foam tape. Very good temperature resistance (220°C/20min & 130°C/permanent) with an outstanding cold shock resistance (down to -40°C). Designed for demanding outdoor bonding applications
- > Thickness: 2.0 mm

Size (mm x m)	Cat. No.
9 x 18	003.58.100
12 x 18	003.58.101
25 x 18	003.58.102

**Packing:** 1 roll





## SIA ABRASIVES – WE ARE YOUR ABRASIVES SPECIALISTS

We are passionate about professional abrasive solutions for industry and trades.

Our clearly defined abrasive processes for all materials and applications mean that we can always find the right approach to achieving the perfect surface finish.

As one of the world's largest manufacturers of high-quality abrasive products, we develop and produce abrasives with a wide variety of shapes, dimensions and specifications.



### SOLUTIONS FOR PROFESSIONALS EFFICIENT AND ECONOMICAL



- > Abrasive solutions from SIA Abrasives are used across a variety of industries.
- > Comprehensive sanding process analyses result in fast and cost-saving applications.
- > The productivity of the work process is the ultimate goal.

### TOP QUALITY INNOVATIVE TECHNOLOGY LEADER



- > The latest production methods and technologies guarantee the highest quality.
- > Processes with ultrasonic monitoring ensure the continually high level of quality.
- > Standardised testing methods guarantee the utmost product safety.

### PROFESSIONAL PARTNER TECHNICALLY VERSED AND EXPERIENCED



- > From professionals for professionals: Optimum consultation to help you achieve great sanding results.
- > Our expert advisers have a lot of technical experience and will find the perfect abrasive solution for you.
- > There for you, wherever you are. Represented globally in over 80 countries.

### PERFECT SURFACE FINISH FINISH BY SIA ABRASIVES



- > A perfect surface finish offers protection, enhances design and aesthetic aspects or increases functionality.
- > We support you in getting the best out of every surface.
- > Your specifications are our goal.



## SIA 7983 SIASPONGE FLEX PADS



- > Can be used wet or dry, colour coded for easy identification. Low clogging thanks to 3D properties imparted by foam. For hard-to-reach areas and round profiles. Consistent surface finishes even on curved workpieces, regular scratch depth due to consistent grinding performance. Minimal risk of sanding through from high contact pressure
- > Keying of wood and plastics, keying conventional old and new varnishes, primer filler and paints. Fine sanding primer filler in hard-to-reach areas. Producing a matt finish on varnishes, flattening body filler and primer filler and intermediate sanding of varnishes
- > Grit type: Aluminium oxide
- > Backing: PU foam (soft)

Size (mm)	Grit	Colour	Cat. No.
98 x 120	Medium	Orange	005.48.471
	Fine	Yellow	005.48.472

**Packing:** 1 pack (10 pieces)

## SIA 7990 SIASPONGE BLOCKS



- > Can be used wet or dry, colour coded for easy identification. Low clogging. Coated on all four sides, ideal for use inside rebates and on flat surfaces
- > Sanding off old varnish, paints and stains. Sanding off raised wooden fibres, fine sanding of surfaces. Sanding off rusted parts, and old paint and varnish. Keying surfaces for better paint adhesion, flattening uneven areas. Keying or sanding surfaces, keying smoothed surfaces
- > Grit type: Aluminium oxide
- > Backing: PU foam (hard)

Size (mm)	Grit	Colour	Cat. No.
69 x 98	Medium	Orange	005.48.480
	Fine	Yellow	005.48.481

**Packing:** 1 pack (10 pieces)

## SIA 6120 SIAFLEECE SHEET



- > Low clogging, suitable for general use in dry and wet sanding applications. Highly flexible and adaptable to contours, for manual or portable machine sanding
- > Removal of rust, removing discolouration, structuring/finishing
- > Grit type: Aluminium oxide/Silicon carbide

Size (mm)	Grit	Cat. No.
152 x 229	very fine A XS (maroon)	005.16.227

**Packing:** 1 pack (20 pieces)

## SIA 1948 SIAFLEX SHEETS

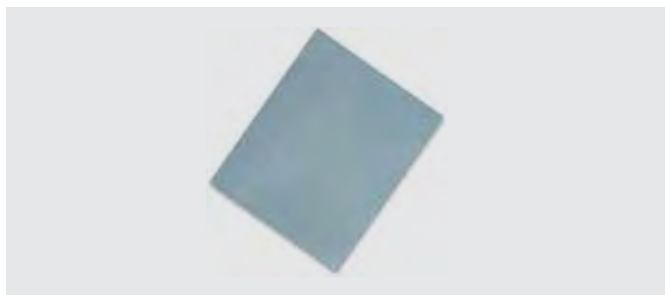

- > Versatile all-round product, minimal clogging thanks to open coating in 80 - 400 grit range. High performance for stock removal with good finish. Highly flexible and adaptable to contours, long lifetime. Suitable for general use in dry and wet sanding applications.
- > Sanding off coatings and impurities. Sanding out unevenness at the edges of repaired surfaces, flattening body filler and primer filler, fine sanding primer filler. Keying old and new lacquers, removing orange peel effect and dust inclusions
- > Grit type: Blue-fired/white aluminium oxide
- > Backing: Fibre-reinforced latex paper

Size (mm)	Grit	Cat. No.
230 x 280	80	005.16.210
	120	005.16.212
	150	005.16.213
	180	005.16.214
	240	005.16.216
	320	005.16.218
	400	005.16.219

**Packing:** 1 pack (50 pieces)

## SIA 1948 SIAFLEX PAPER ROLLS

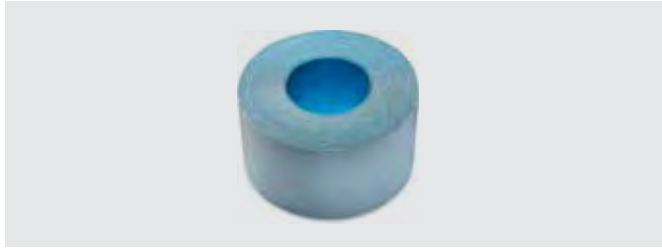

- > Minimal clogging thanks to open coating in 80 - 400 grit range. Versatile all-round product with an attractive range of options. High performance for stock removal with good finish, highly flexible and adaptable to contours. Long lifetime, suitable for general use in dry and wet sanding applications
- > Sanding off coatings and impurities. Sanding out unevenness at the edges of repaired surfaces, flattening bodyfiller and primer filler, fine sanding primer filler. Keying old and new lacquers. Removing orange peel effect and dust inclusions
- > Grit type: Blue-fired/white aluminium oxide
- > Backing: Fibre-reinforced latex paper

Size (mm x m)	Grit	Cat. No.
115 x 50	80	005.51.092
	120	005.51.093
	150	005.51.094
	180	005.51.095
	240	005.51.096
	320	005.51.097
	400	005.51.098

**Packing:** 1 roll

## SIA 7900 SIANET HOOK & LOOP ROLLS



- > Full-surface dust extraction. High removal rate without clogging, very efficient and productive. High tear resistance, thanks to sturdy net backing
- > Sanding off rusted parts, old varnish, paints and stains, raised wooden fibres, floorboards, wooden terraces and pool surrounds. Keying or sanding surfaces, keying smoothed surfaces, keying surfaces for better paint adhesion. Fine sanding of surfaces, flattening uneven areas and lightweight construction walls
- > Grit type: Blue-fired/white aluminium oxide/ Hook and loop
- > Backing: Knitted fabric

Size (mm x m)	Grit	Cat. No.
70 x 10	80	005.03.070
	120	005.03.071
	150	005.03.072
	180	005.03.073
	240	005.03.074
	320	005.03.075
	400	005.03.076
115 x 10	80	005.03.060
	120	005.03.062
	150	005.03.063
	180	005.03.064
	240	005.03.065
	320	005.03.066
	400	005.03.067

**Packing:** 1 roll

## SIA CORK HAND BLOCK



- > Single sided
- > Hook and loop system
- > Dimensions: 70 x 125 x 40 mm

Cat. No.
005.58.512

**Packing:** 1 piece

## SIA DOUBLE SIDED HAND BLOCK

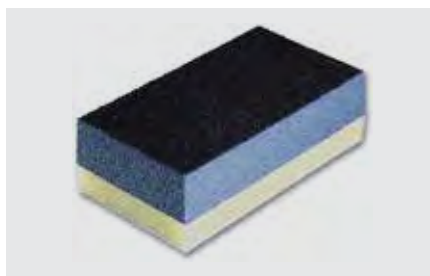

- > Medium hard (blue) and Extra soft (white)
- > Hook and loop system
- > Dimensions: 70 x 125 x 38 mm

Cat. No.
005.58.511

**Packing:** 1 piece

## SIA DUST EXTRACTION HAND BLOCK



- > Ergonomic grip, with dust extraction. Optimised hardness for a wide range of sanding processes
- > Hook and loop system
- > Dimensions: 70 x 125 mm
- > Hole pattern: 29 hole

Cat. No.
005.51.940

**Packing:** 1 piece

## SIA 7900 SIANET DELTA SHEETS



- > Full-surface dust extraction. High removal rate without clogging, very efficient and productive. High tear resistance, thanks to sturdy net backing
- > Sanding off rusted parts, old varnish, paints and stains, raised wooden fibres, floorboards, wooden terraces and pool surrounds. Keying or sanding surfaces, keying smoothed surfaces, keying surfaces for better paint adhesion. Fine sanding of surfaces, flattening uneven areas and lightweight construction walls
- > Grit type: Blue-fired/white aluminium oxide / Hook and loop
- > Backing: Knitted fabric

Size (mm)	Grit	Cat. No.
100 x 147	80	005.03.110
	120	005.03.112
	180	005.03.114
	240	005.03.115
	320	005.03.116

**Packing:** 1 pack (50 pieces)

## SIA 2920 SIAWOOD X SANDING BELT



- > A robust cotton fabric backing which ensures outstanding performance as well as excellent removal rates, lifetime and finish in portable belt sanding applications.
- > Suitable for long periods of use thanks to very robust backing and optimised grit spreading technology. Ideal for manual belt sanding
- > Sanding off old varnish, paints and stains, fine sanding of surfaces
- > Can be used on softwood, hardwood, resinous wood, old lacquer, plywood panel, solid surface material
- > Grit type: Aluminium oxide
- > Backing: x-wt cloth 40 grit, cotton 60 to 120 grit
- > Grit range: 40 - 120

Size (mm)	Grit	Cat. No.
75 x 533	40	005.03.400
	60	005.03.401
	80	005.03.402
	120	005.03.404
75 x 610	40	005.03.410
	60	005.03.411
	80	005.03.412
	120	005.03.414
100 x 610	40	005.03.420
	60	005.03.421
	80	005.03.422
	120	005.03.424

**Packing:** 1 pack (10 pieces)

## SIA 1948 SIAFLEX DISCS

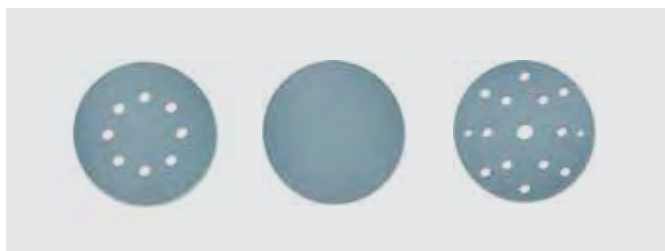

- > Suitable for general use in dry and wet sanding applications. Sanding off of coatings and impurities and unevenness at the edges of repaired surfaces. Flattening of body filler and prime filler, fine sanding of primer filler. Keying of old and new varnishes. Removal of orange-peel effect and dust inclusions
- > High stock removal, highly flexible and adaptable to contours. Minimal clogging, open coating in 240 - 500 grit range, long lifetime
- > Grit type: Blue-fired aluminium oxide / white aluminium oxide
- > Backing: Fibre reinforced latex paper / Hook and loop

Size Ø (mm)	Hole pattern	Pack Qty	Grit	Cat. No.
125	8 holes	100 pieces	80	005.52.310
			120	005.52.311
			150	005.52.312
			180	005.52.313
			240	005.52.314
			320	005.52.315
150	Without holes	100 pieces	400	005.52.316
			80	005.52.040
			120	005.52.041
			150	005.52.042
			180	005.52.043
			240	005.52.044
150	15 Holes	100 pieces	320	005.52.045
			400	005.52.046
			500	005.52.047
			80	005.52.030
			120	005.52.031
			150	005.52.032
			180	005.52.033
			240	005.52.034
			320	005.52.035
			400	005.52.036
		50 pieces	500	005.52.037
			600	005.52.038
			800	005.52.039

**Packing:** 1 pack

## SIA PAD SAVER



## SIA 7900 SIANET DISCS



- > Full-surface dust extraction. High removal rate without clogging, very efficient and productive. High tear resistance, thanks to sturdy net backing
- > Sanding off rusted parts, old varnish, paints and stains, raised wooden fibres, floorboards, wooden terraces and pool surrounds. Keying or sanding surfaces, keying smoothed surfaces, and keying surfaces for better paint adhesion. Fine sanding of surfaces, flattening uneven areas and lightweight construction walls
- > Grit type: Blue-fired/white aluminium oxide / Hook and loop
- > Backing: Knitted fabric

Size Ø (mm)	Grit	Cat. No.
125	80	005.03.080
	120	005.03.081
	180	005.03.082
	240	005.03.083
	320	005.03.084
150	400	005.03.085
	80	005.52.020
	120	005.52.021
	150	005.52.022
	180	005.52.023
	240	005.52.024
	320	005.52.025
	400	005.52.026

**Packing:** 1 pack (50 pieces)

Size Ø (mm)	Hole pattern	Thickness (mm)	Cat. No.
123	45 holes	1	005.51.941
150	103 holes	1	005.51.942
		10	005.51.943

**Packing:** 1 pack (2 pieces)

## SIA HOOK & LOOP BACKING PAD



- > 5/16
- > Hook and loop system

Size Ø (mm)	Hole pattern	Grit	Cat. No.
125	No hole	Soft	005.58.505
150	54 hole	Soft	005.58.506
		Hard	005.58.507

**Packing:** 1 piece

## SIA HOOK & LOOP MULTI HOLE BACKING PAD



- > 5/16 and M8
- > For multi-hole and mesh-type abrasive discs
- > Hook and loop system
- > Supplied with: Festool adaptor

Size Ø (mm)	Hole pattern	Grit	Cat. No.
150	103 holes	Extra soft	005.58.508
		Soft	005.58.509
		Hard	005.58.510

**Packing:** 1 piece

## SIA 7940 SIAAIR SOILD SURFACE DISCS



- > High stock removal rates and excellent finish. Low clogging in damp and dry sanding applications. Highly adaptable to contours, curves and profiles, pressure-equalising foam gives perfect surface finish. Waterproof and washable, resistant to silicon remover
- > Matt finishing of conventional old and new varnishes as well as composite materials. Fine sanding primer filler in hard-to-reach areas. Preparation for polishing on high-gloss surfaces
- > Grit type: Aluminium oxide
- > Backing: Knitted fabric with foam backing / Hook and Loop

Size Ø (mm)	Grit	Cat. No.
150	360	005.52.027
	500	005.52.028
	600	005.52.029
	800	005.52.240
	1000	005.52.241
	1500	005.52.242
	2000	005.52.243
	3000	005.52.244
	4000	005.52.245

**Packing:** 1 pack (10 pieces)

## SIA BACKING PAD

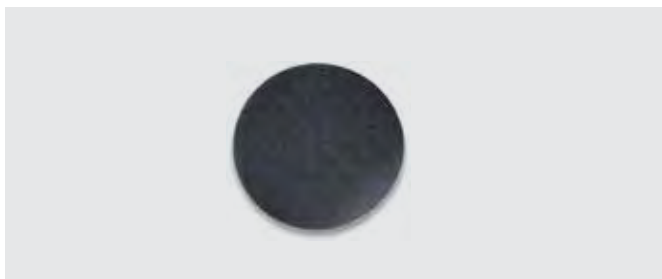

- > Backing disc for wet sanding that protects the orbital machine against the water penetration when using 7940 siaair discs
- > Hook and loop system

Size Ø (mm)	Hole pattern	Cat. No.
145	No hole	005.58.515

**Packing:** 1 pack (2 pieces)

## SIACHROME CUT



- > Highly effective scratch remover based on a high-purity aluminium oxide for lasting removal of severe signs of use and scratches from all types of paint. Produces a long-lasting and rich deep gloss. Does not contain waxes, silicone oils or other fillers.
- > 1 kg

	Cat. No.
	005.58.504

**Packing:** 1 piece

## SIA LAMBSWOOL PAD



- > For restoring gloss on old paint finishes with siachrome CUT
- > Dimensions: Ø135 mm

	Cat. No.
	005.58.110

**Packing:** 1 pack (2 pieces)

## SIA POLISHING DISC



- > For application with siachrome CUT
- > Dimensions: Ø145 mm

	Cat. No.
	005.58.514

**Packing:** 1 pack (2 pieces)

## SIA MICROFIBRE CLOTH



- > For cleaning paint finishes after polishing with siachrome CUT

	Cat. No.
	005.58.516

**Packing:** 1 pack (3 pieces)

## SIA BACKING PAD



- > Backing pad for polishing and lambskin pads.
- > Hook and loop system

Size Ø (mm)	Hole pattern	Cat. No.
150	No hole	005.58.503

**Packing:** 1 piece

## SPEED-GRIP ABRASIVE DISCS



- > To suit multi-tool and air tools, Bosch GEX 150A, PEX 15AE, Rupes
- > Diameter: Ø150 mm

Grit	6 hole	9 hole
P80C	-	005.57.060
P120C	005.57.072	005.57.061
P180C	005.57.073	005.57.062
P240C	005.57.074	005.57.063
P320C	-	005.57.064

**Packing:** 1 pack (100 pieces)

## NO-FIL ADALOX



- > Paper backed rolls
- > Openkote for light sanding of painted surfaces where loading is a problem
- > Size: 115 mm x 50 m

Grit	Cat. No.
P80C	005.57.110
P120C	005.57.112
P180C	005.57.113
P240C	005.57.114
P320C	005.57.115

**Packing:** 1 roll

## PAPER BACKED SHEETS



- > Openkote for timber and painted surfaces
- > Size: 230 x 280 mm

Grit	Cat. No.
P100C	005.57.120
P120C	005.57.121
P180C	005.57.123

**Packing:** 1 pack (50 pieces)

## COATED ABRASIVE BELTS



- > Cloth backed belts for portable belt sanders

Grit	Cat. No.
<b>75 x 610 mm</b>	
P80	005.57.031
<b>100 x 610 mm</b>	
P60X	005.57.040
P80X	005.57.041
P100X	005.57.042
P120X	005.17.550

**Packing:** 1 pack (10 pieces)



### PACKAGING TAPE HAND DISPENSER



- > For convenient application of packaging tapes suitable for tape widths up to 50 mm
- > Hand dispenser with brake, allows application of tapes made of PVC, PP (polypropylene), paper, etc.

	Cat. No.
	007.81.020

**Packing:** 1 piece

### TESA 4256 - GENERAL PURPOSE PACKAGING TAPE



- > General purpose polypropylene carton sealing tape for high volume, packaging and carton sealing for light to medium cartons, rubber adhesive
- > Thickness: 0.04 mm

Size (mm x m)	Colour	Cat. No.
48 x 75	Brown	003.58.295

**Packing:** 1 roll

### TESA 64270 - ECONOMY PACKAGING TAPE



- > General purpose polypropylene carton sealing tape. Suitable for use on recycled board and under shrink wrap. Ideal for use on carton sealing machines as well as manual applications
- > Thickness: 0.04 mm

Size (mm x m)	Colour	Cat. No.
48 x 75	Clear	007.81.134

**Packing:** 1 roll

### FOLDING UTILITY KNIFE



- > Light weight aluminium handle with clip, quick change blade mechanism, spring blade release, one hand operation, locking blade

	Cat. No.
	000.33.140

**Packing:** 1 piece

### MARKING PENS



- > Ideal when a bold mark is required on objects, e.g. benchtops and cabinets. Extra large chisel point tip leaves broad block strokes that are more easily read from a distance. Permanent, waterproof ink creates lasting marks that will remain clear and sharp throughout transit, storage and handling. Ideal for identifying items that have been wrapped with packaging materials

Colour	Description	Cat. No.
Black	Chisel point	007.81.130

**Packing:** 1 pack (12 pieces)

### QUICK RELEASE CABLE TIES



- > Can be released
- > Material: plastic
- > Colour: natural

Length (mm)	Cat. No.
180	079.00.041
240	079.00.042
320	079.00.043

**Packing:** 500 pieces

## BUNDLE WRAP AND DISPENSER

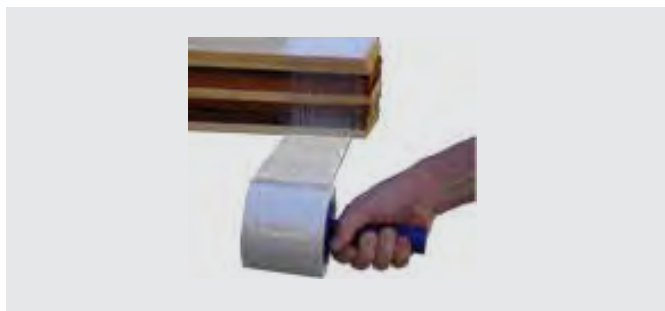

- > For ease of wrapping and packaging
- > Material: Clear LLDPE film

	Cat. No.
Bundle wrap film (100 mm x 300 m x 20 µm)	007.81.055
Bundle wrap film dispenser	007.81.022

**Packing:** 1 roll/piece

## STRETCH WRAP AND DISPENSER



- > For protection of work pieces and materials when storing. Prevents shifting of loads when transporting. Dispenser suitable for roll length of up to 500 mm
- > Inner side of film adherent coated, recyclable
- > Material: LLDPE = Linear low density polyethylene
- > Colour: Clear transparent
- > Film thickness: 22 µm

	Cat. No.
Stretch wrap 500 x 400 mm	007.81.041
Stretch wrap dispenser	007.81.002

**Packing:** 1 roll/piece

## BUBBLE WRAP



- > For ease of wrapping and packaging
- > Material: Clear LLDPE film

Size (mm x m)	Cat. No.
750 x 50	007.81.051

**Packing:** 1 roll

## POLYETHYLENE FOAM

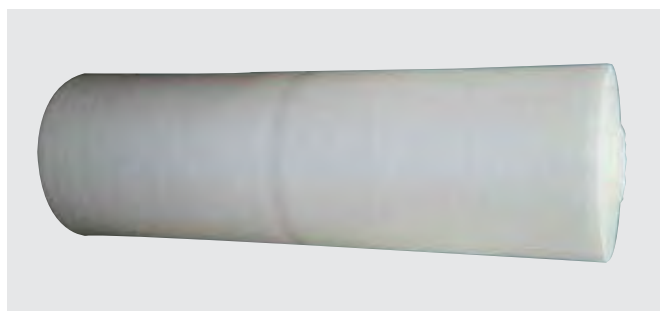

- > Provides protection during transit
- > Easy wrapping and packaging. Recyclable and reusable to protect product through entire distribution cycle. Will not scratch or damage surface
- > Material: White, polyethylene foam

Size	Cat. No.
1 mm x 1200 mm x 100 m	007.81.056

**Packing:** 1 piece

## FURNITURE BLANKET



- > Dimensions: 1500 x 2000 mm
- > Quality: 300 (approximately 300 g/sqm), unhemmed

	Cat. No.
	007.80.101

**Packing:** 1 piece

SURFACE PROTECTION FILM



- > Diamond Guard 127B for use during the painting process
- > For the protection of melamine board and laminates\* Serves as a general purpose film for protecting kitchen benchtops, doors, drawer fronts, panels and other surfaces
- > Solvent resistant, cuts cleanly during most routing and machining operations. Prevents scratching during production processes
- > Film thickness: 0.07 mm cuts
- > Adhesion: 350g/25 mm
- > Colour: Blue tint
- > Storage temp: Room temperature
- > Shelf life: 6 months

Size (mm x m)	Cat. No.
610 x 100	007.81.038

Packing: 1 roll

SURFACE PROTECTION FILM



- > Diamond Guard 346 - high tack
- > For protection of laminates, granite benchtops and many other smooth surfaces. Easily applied by hand - no special tools required
- > Self adhesive does not require any tape or additional fixing, removes cleanly, forms an effective barrier against splashes and prevents scratching
- > Film thickness: 0.07 mm
- > Adhesion: 250g/25 mm
- > Colour: Green tint
- > UV resistance: Recommended max. 3 months external use

Size (mm x m)	Cat. No.
610 x 100	007.81.146

Packing: 1 roll

CARRYING HANDLE

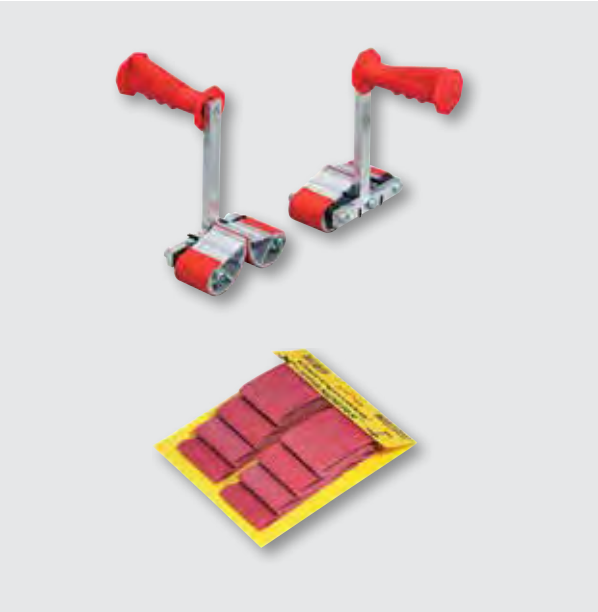

- > Ergonomic handles, self-adjusting and self-gripping clamping system, aluminium
- > Load bearing capacity: 100 kg per handle

Span width (mm)	Cat. No.
0 - 80	007.90.232

Packing: 1 pair

	Cat. No.
Replacement Rubber layer for carrying handle	007.90.240

Packing: 1 set (8 pieces)

STANDARD BOARD CARRY HANDLE



- > For panels and elements up to 40 mm

	Cat. No.
	007.90.205

Packing: 1 pair

HEAVY DUTY BOARD CARRY HANDLE



- > For panels and elements up to 70 mm
- > Load bearing capacity: 120 kg per handle

	Cat. No.
	007.90.250

Packing: 1 pair

BOARD CARRY HANDLE WITH CLAMPS



- > For panels and elements up to 40 mm
- > Load bearing capacity: 80 kg per handle

	Cat. No.
	007.90.456

Packing: 1 pair

Dimensions in mm Dimensional data not binding. We reserve the right to alter specifications without notice.

GORILLA GRIPPER BOARD CARRY HANDLE



- > Extremely easy transport, even large panels, by one person, the special angular position protects arms, back, wrists and fingers. Plastic, with non-slip handle and clamping mechanism, for panel thickness from 0.1 to 24 mm
- > Load bearing capacity: 55 kg



	Cat. No.
	007.90.150

Packing: 1 piece

UR 220 SECURING STRAP

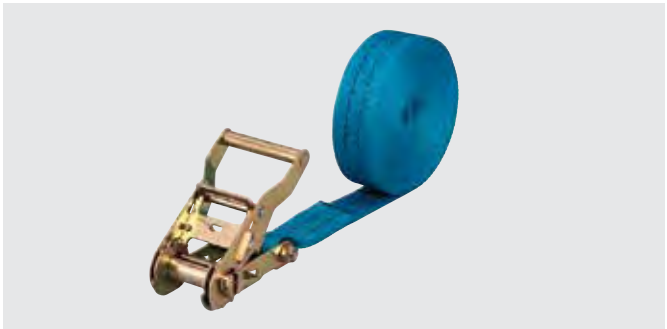

- > Single strap with lever ratchet
- > Strap length: 6 m
- > Strap width: 35 mm
- > Tensile strength: 1000 daN
- > Breaking strength: 2000 daN

	Cat. No.
	008.54.651

Packing: 1 piece

HANDLE ON DEMAND



- > Stop straining your back trying to lift heavy stuff. Handle on Demand (HOD) comes in single or double. Just fasten the suction pads to any nonporous surface and move it, lift it, place it, & transport it with ease.
- > Can be used for glass, cabinets and countertops
- > Heavy duty design, amazing suction holding power, lever locks for security

	Cat. No.
Single	008.54.470
Double	008.54.471

Packing: 1 pair

TRANSPORT TROLLEY WITH SHOCK PROTECTION



- > Non-slip coated, with 4 swivel castors (2 with brake), suitable as a support for all common aluminium boxes, water repellent
- > Dimensions (L x W): 520 x 320 mm
- > Load bearing capacity: 200 kg

Cat. No.
007.80.016

Packing: 1 piece

TRANSPORT TROLLEY WITH SOFT CASTORS



- > Non-slip coated, 4 soft castors for protecting sensitive floors
- > Dimensions (L x W): 575 x 295 mm
- > Load bearing capacity: 250 kg

Cat. No.
007.80.013

Packing: 1 piece

TRANSPORT TROLLEY WITH DRAWBAR



- > Non-slip coated, 2 swivel castors, 2 fixed castors, soft castors with diameter 100 mm, collapsible and height adjustable drawbar, integrated carrying handles.
- > Dimensions (L x W): 800 x 400 mm
- > Load bearing capacity: 300 kg

Cat. No.
007.80.015

Packing: 1 piece

SPEED SKATE



- > The Speed Skate allows you to move large & heavy materials around the job or shop by yourself. It easily supports 1200mm x 2400 mm sheets of material up to 44mm thick. Large wheels and ball bearings allow you to move boards without any struggle
- > Load bearing capacity: 220 kg

Cat. No.
007.80.043

Packing: 1 piece

SPEED DOLLIE



- > Move awkward cabinets effortlessly with just one person. In just three easy steps you'll be done. The Speed Dollie can be used by anyone for moving heavy awkward items that you just can't move alone

Cat. No.
007.80.042

Packing: 1 piece



FITTING CASE WITH 8 REMOVABLE BOXES



- > Dimensions (W x D x H): 423 x 334 x 98 mm
- > Material: plastic

	Cat. No.
	008.05.710

**Packing:** 1 piece

FITTING CASE WITH 14 COMPARTMENTS



- > Dimensions (W x D x H): 340 x 260 x 60 mm
- > Material: plastic
- > Finish: anthracite and transparent

	Cat. No.
	008.05.700

**Packing:** 1 piece

11TH FINGER



- > Keep your fingers safely away from the saw blade with the 11th Finger. The durable nylamax push stick was constructed to prevent damage to your saw blade

	Cat. No.
	001.66.800

**Packing:** 1 piece

BLUE DOG



- > The Blue Dog is a product that gives great functionality to your workbench when dogs are needed. Simply use a 63.5 mm hole saw to drill out a hole, sand the top edge, and press the Blue Dog down into the hole until flush. Detents allow easy and accurate height adjustment for any material thickness and the turntable feature allows great flexibility on your workbench. Another great product developed by a cabinet maker on the shop floor.

	Cat. No.
Single	003.74.805
4 pack	003.74.806

**Packing:** 1 piece/set

# IMPACT

## CUSTOMISED BENCHTOPS

Häfele now offers cut to size and finished benchtops in Dekton LITE™, Mirostone®, Duropal® Quadra laminate and Compact Laminate, all through our easy to use Impact Benchtop configurator via the Häfele website. Visit [hafele.com.au](http://hafele.com.au) to find out more or check with your Häfele representative to see how easy it is to order online.

### Our promise:

- Online 24/7 quoting and ordering.
- Dispatched in 48 hours directly to you.
- Made to measure & cut to size including optional sink and cooktop cut-outs.
- Sustainably sourced and Safely manufactured.
- All benchtops come with a 10 year limited warranty.





Consumables & Tools Catalogue - 11.2021

**Häfele Australia Pty. Ltd.** | 8 Monterey Road | Dandenong | Victoria 3175  
**Phone:** 1300 659 728 | **Fax:** (03) 9212 2001 | **Email:** [info@hafele.com.au](mailto:info@hafele.com.au) | [www.hafele.com.au](http://www.hafele.com.au)

**Häfele New Zealand Ltd.** | 16 Accent Drive | East Tamaki | Auckland 2013  
**Phone:** 0800 442 335 | **Email:** [info@hafele.co.nz](mailto:info@hafele.co.nz) | [www.hafele.co.nz](http://www.hafele.co.nz)

**HÄFELE LOCATIONS:**

**Australia** | MELBOURNE | SYDNEY | NEWCASTLE | BRISBANE | ADELAIDE | LAUNCESTON | HOBART | PERTH  
**New Zealand** | AUCKLAND | WELLINGTON | CHRISTCHURCH

